



SW

ACTIVE SAFETY



OSAS

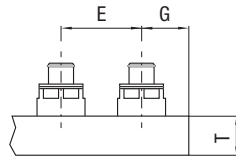
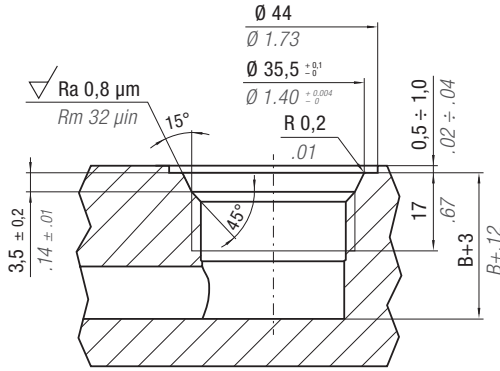

P*		E min		G min	
psi	bar	inch	mm	inch	mm
1500	103	4.45	114	2.50	64
2000	138	5.38	137	3.00	77

P* = Charging pressure

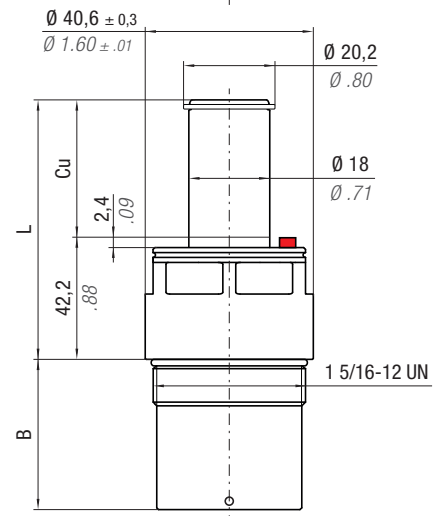
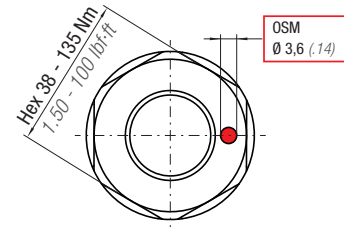

Max Speed 315 ft/min 1,6 m/s	32 - 176 °F 0 - 80 °C	N ₂	P max 2000 psi 138 bar	P min 363 psi 25 bar	S .761 in ² 4,91 cm ²	
---	--------------------------	----------------	-------------------------------------	-----------------------------------	--	--

PART NUMBER	F ₀ Initial Force		C _u		L		B		T*min		T**min			
	.5 ton 500 daN	.75 ton 750 daN	inch	mm	inch	mm	inch	mm	inch	mm	inch	mm	~ lb	~ Kg
CRD 750 - 0.25 - A			0.25	6,4	1.91	48,5	0.59	15,0	1.73	44,0	1.89	48,0	0.85	0,39
CRD 750 - 0.50 - A			0.50	12,7	2.16	54,8	0.59	15,0	1.73	44,0	1.89	48,0	0.88	0,40
CRD 750 - 0.75 - A			0.75	19,1	2.41	61,2	0.63	16,0	1.73	44,0	1.89	48,0	0.91	0,41
CRD 750 - 1.00 - A			1.00	25,4	2.66	67,6	0.88	22,4	1.73	44,0	1.89	48,0	0.96	0,44
CRD 750 - 1.50 - A			1.50	38,1	3.16	80,3	1.38	35,1	1.81	46,0	1.93	49,0	1.07	0,48
CRD 750 - 2.00 - A			2.00	50,8	3.66	93,0	1.88	47,8	2.32	59,0	2.44	62,0	1.17	0,53
CRD 750 - 2.50 - A			2.50	63,5	4.16	105,7	2.38	60,5	2.80	71,0	2.95	75,0	1.27	0,58
CRD 750 - 3.00 - A			3.00	76,2	4.66	118,4	2.88	73,2	3.31	84,0	3.43	87,0	1.38	0,63
CRD 750 - 3.50 - A			3.50	88,9	5.16	131,1	3.38	85,9	3.82	97,0	3.94	100,0	1.48	0,67
CRD 750 - 4.00 - A			4.00	101,6	5.66	143,8	3.88	98,6	4.29	109,0	4.45	113,0	1.59	0,72

T* = 1500 psi/103 bar T** = 2000 psi/138 bar



HOW TO ORDER

p. 27



ACCESSORIES

p. 47

SERVICE TOOLS

p. 68

Part Number 58UT044A

MAINTENANCE KIT

Part Number 39BMCRO0750A