

# LINKED SYSTEM SELECTION

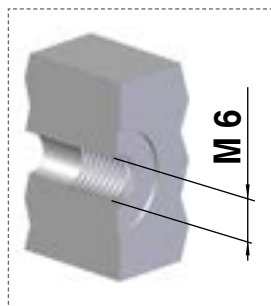

**FLEXFLOW - CONNECTIONS**  
S12,65x1,5

**TMA**

Low gas flow

**MICRO - CONNECTIONS**  
M8x1

Twin seal

**TSM**

Low gas flow

**JIC 37° - CONNECTIONS**  
7/16"-20 UNF

**TNC**

High gas flow

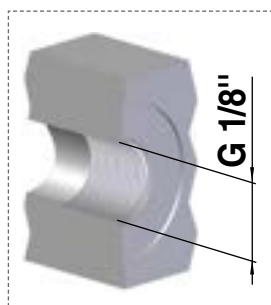

**ORFS - CONNECTIONS**  
9/16"-18 UNF

**HY 400**

High gas flow

**EO - 24° - CONNECTIONS**  
M12x1,5

Twin seal

**HY 500**

High gas flow

## IT

- Pressa trasportabile con pompa pneumatica idraulica  
- Idonea per raccordi dritti, 45° e 90°

## EN

- Transportable press with hydraulic manual pump  
- Suitable for straight, 45° and 90° fittings

## DE

- Transportable Presse mit manueller Hydraulikpumpe  
- Geeignet für gerade, 45° und 90° Anschlüsse

## FR

- Presse transportable avec pompe oléodynamique manuelle  
- Utilisable avec raccords droits, 45° et 90°

## ES

- Prensa transportable con bomba oleodinámica manual  
- Puede ser utilizada con tuberías derechas, 45° y 90°

## PT

- Prensa transportável com bomba hidráulica manual  
- Pode ser usado com tubos retos, 45° e 90°

### code 39PR06



### code 58UT022A (included)



**IT** Utensile rimuovi morsetti con calamita  
**EN** Magnet tool to remove pressing jaws  
**DE** Magnetwerkzeug für die Entfernung von Pressbacken  
**FR** Outil magnétique pour enlever les mâchoires de pressage  
**ES** Herramienta magnética para sacar las mordazas de la prensa  
**PT** Ferramenta magnética para remover os mordentes de prensar

### code 58UT001A (optional)



**IT** Forbice taglia tubo  
**EN** Scissor for hose  
**DE** Schlauchschneideschere  
**FR** Ciseaux coupe-tube  
**ES** Tijeras cortatubos  
**PT** Tesouras corta tubos

### code 58UT023A (optional)



**IT** Lampada led con magnete  
**EN** LED Light with magnet  
**DE** LED-Lampe mit Magnet  
**FR** Lampe à LED magnétique  
**ES** Lámpara LED con imán  
**PT** Lâmpada LED com íman

<b>AIR</b>		L x P x H	Kg	°F °C
7 bar 110 psi	100 TON 110 US TON	380 x 430 x 400 mm 15 x 17 x 16 inch	38 kg 84 lb	-5 ÷ 40 °C 23 ÷ 104 °F

CONNECTIONS	ORFS "TSM" HOSE Ø 5,5 p. 288	Micro 32° - JIC 37° "TSM" HOSE Ø 5,5 p. 272 - 273	FlexFlow "TMA" HOSE Ø 5,1 p. 275	JIC 37° "TNB" HOSE Ø 8 p. 273	EO 24° "HY 500" HOSE Ø 11 p. 268	ORFS "HY 400" HOSE Ø 12,7 p. 284
PRESSING JAWS	code 39MTR10 (optional) 	code 39MTR11 (optional) 	code 39MTR12 (optional) 	code 39MTR13 (optional) 		

Ordering example: **39PR06A + 39MTR11** | Pressing jaws for Jic 37° "TNB" HOSE Ø 8,1

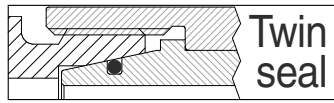

code 36HY50001...

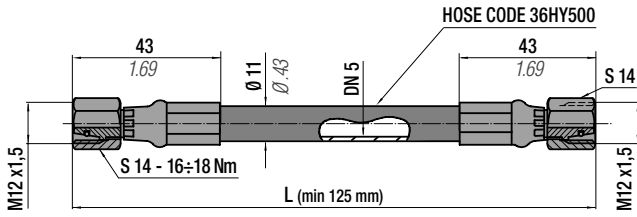

code 36HY50002...

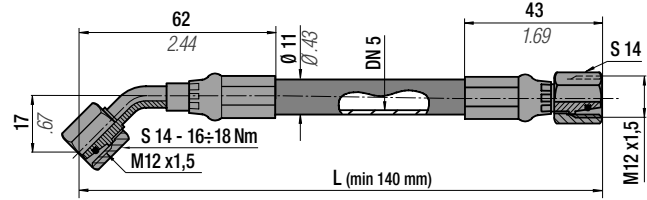

code 36HY50003...

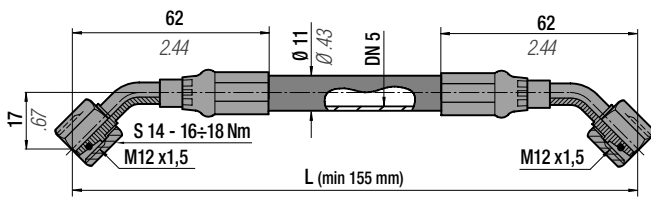

code 36HY50003...V1

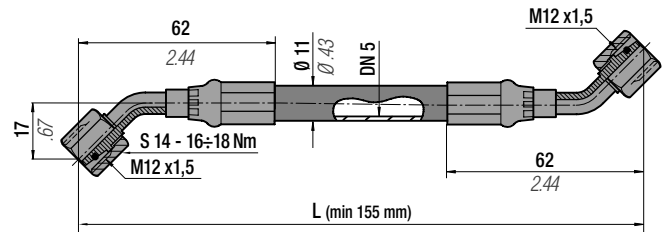

code 36HY50005...

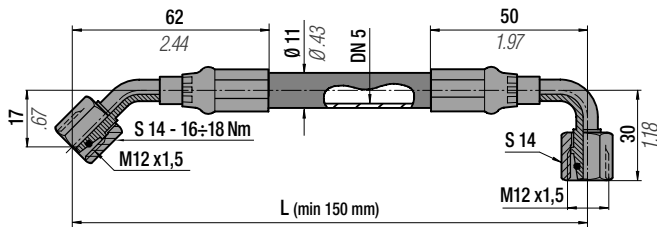

code 36HY50005...V1

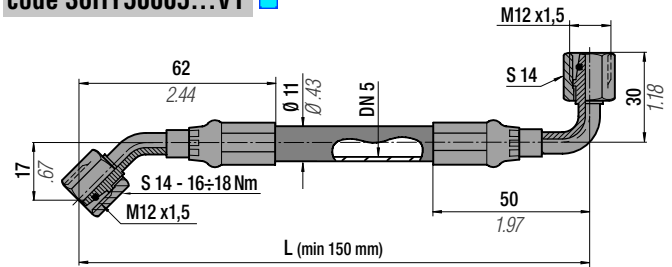

code 36HY50006...

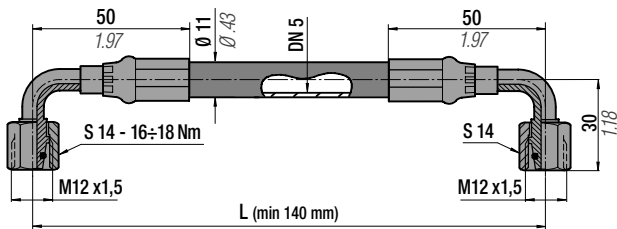

code 36HY50006...V1

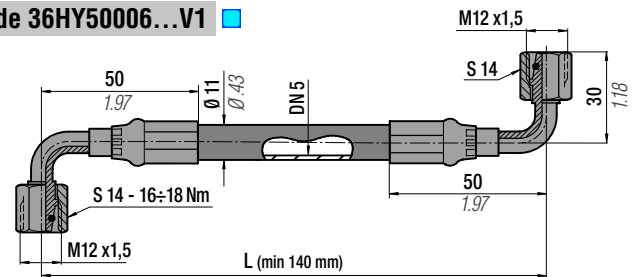

code 36HY50004...

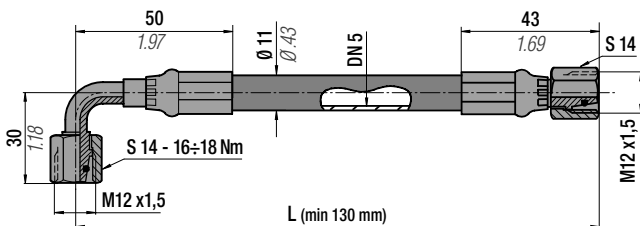

Technical data				
"L" min	See each type	-	Volume	18 ml/metre
Operation pressure	345 bar	5003 psi	Dimension	3/16" (external ø 11 mm)
Burst Pressure	1380 bar at 20°C	20010 psi at 68°F	Material	Thermoplastic
R (bending radius)	40 mm	1.57 in	Standard	SAE 100R8
Operation temperature	-40+ 100°C	-38+212°F	Outer casing	Perforated



Lunghezza richiesta comprensiva di raccordi terminali  
 Length upon request including end hose fittings  
 Länge Anfrage einschließlich Ende Schlaucharmaturen  
 Longueur requise, y compris des raccords d'extrémité  
 Longitud requerida, incluyendo racores de los extremos  
 Comprimento necessário incluindo todos os acessórios

L = 5 mm upward increase - Example (36HY50001 0300; 36HY50001 0305; ...)

## HOSE FITTINGS

code 36P2401

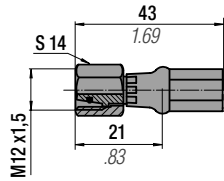

code 36P2402

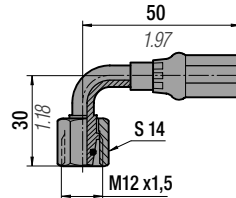

code 36P2403

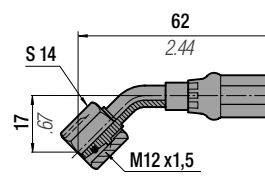

code: 36FF13A

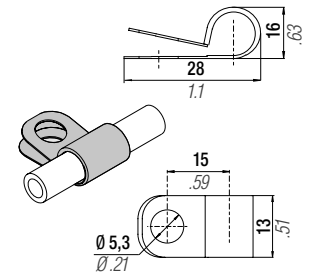

Raccordi tubo-cilindro/pannello - Hose-cylinder/panel connections - Anschlüsse zwischen schlauch und Zylinder/Kontrollarmatur -  
 Raccords tuyau-cylindre/tableau - Racores manguera-cilindros/panel - Racord tubo-cilindro/panel

code 36R2401

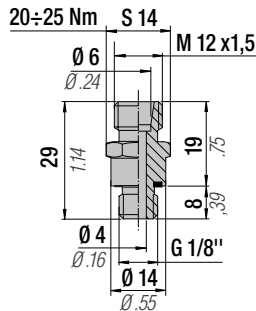

code 36R2402

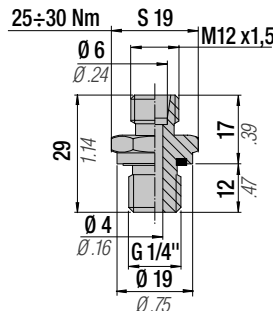

Raccordi di derivazione - Offtake connections - Anschlußstutzen - Raccords de dérivation - Racores de derivación - Racord de derivação

code 36R2403

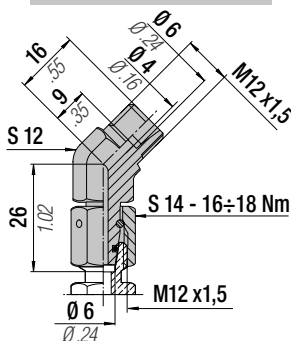

code 36R2404

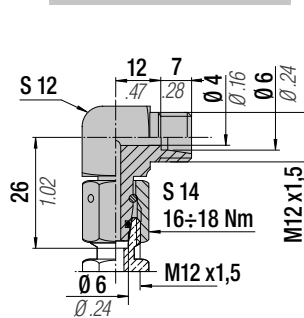

code 36R2405

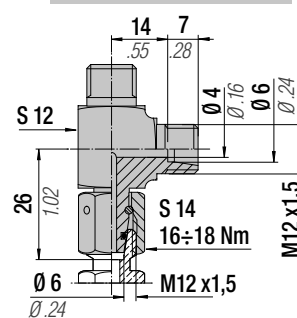

code 36R2406

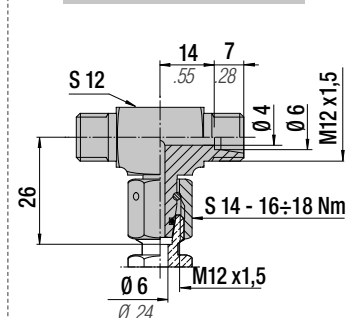

Raccordi tubo-tubo - Hose-hose connections - Anschlüsse zwischen Schlauch und Schlauch - Raccords tuyau-tuyau - Racores tubo-tubo - Racord tubo-tubo

code 36R2407

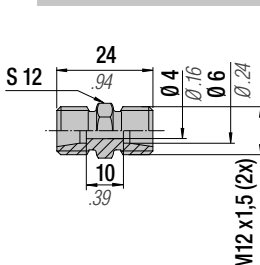

code 36R2408

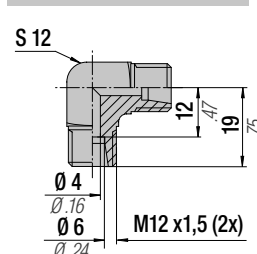

code 36R2409

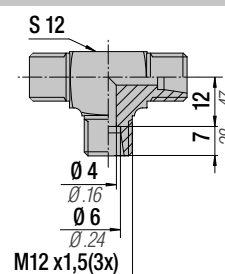

code 36R2410

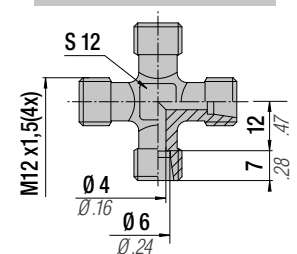

All dimensions in mm/inch

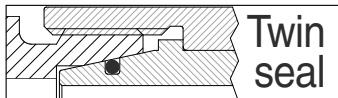

Esempi di installazione - Installation examples - Einbaubeispiele - Exemples de montage - Ejemplos de instalación - Exemplos de instalação

