



**OSAS + OSM** = OVER STROKE ACTIVE SAFETY + OVER STROKE MARKER

## ACTIVE SAFETY

Il nuovo codice sarà fornito solo ad esaurimento del vecchio

The new code will be supplied only when the old will be out of stock

Der neue Kode wird nur angegeben, wenn der alte nicht mehr lieferbar ist

Le nouveau code sera fourni uniquement lorsque le vieux stock sera écoulé

El nuevo código será suministrado sólo cuando se agoten las existencias del antiguo

O novo código irá ser fornecido apenas quando o antigo esgotar stock



OSAS



USAS



OPAS

**easu** MANIFOLD p. 247

\*  $F_{1i}$  = Isothermal end force at 100% Cu p. 16

\*\*  $F_{1p}$  = Polyphotic end force at 100% Cu

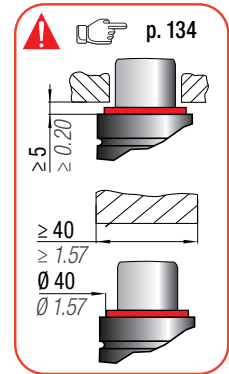
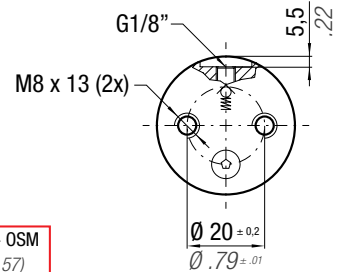
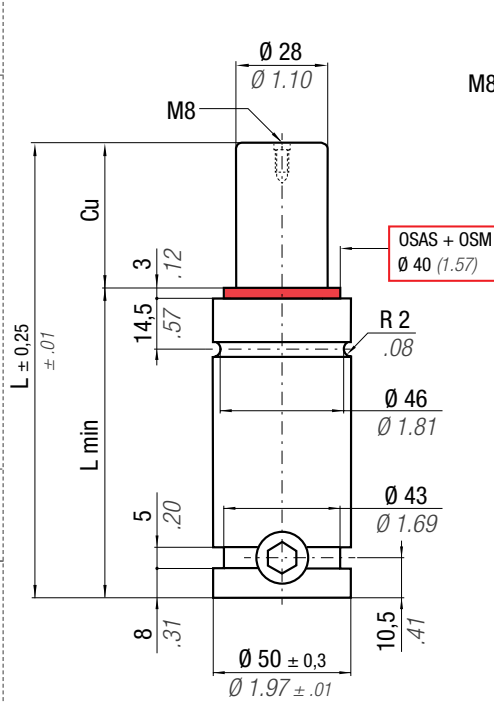

<b>N<sub>2</sub></b>	0 - 80 °C 32 - 176 °F	<b>ΔP</b> ± 0,33 %/°C	<b>P max</b> 150 bar 2175 psi	<b>P min</b> 20 bar 290 psi	<b>S</b> 6,15 cm <sup>2</sup> 0,953 in <sup>2</sup>	<b>SPM</b> ~ 15 - 100 (at 20°C)	<b>Max Speed</b> 1,8 m/s 70,8 in/s	<b>Maintenance kit</b> 39BMH01000D
----------------------	--------------------------	--------------------------	-------------------------------------	-----------------------------------	---	---------------------------------------	--	---------------------------------------

CODE PHASING OUT from 04/2021	NEW	Cu		L		L min		F <sub>0</sub>		F <sub>1i</sub> *		F <sub>1p</sub> **		V <sub>0</sub>		PED 2014/68/EU		
		mm	inch	mm	inch	mm	inch	daN	lb	daN	lb	daN	lb	cm <sup>3</sup>	in <sup>3</sup>		~Kg	~lb
H 1000 - 013 - D	♦ H 1000 - 013 - E	13	0.50	120,7	4.74	107,7	4.24	920 2068 ± 5%  150 bar 2175 psi  + 20 °C +68 °F		1201	2701	1371	3082	40	2.47	1,21	2,67	✓
H 1000 - 025 - D	H 1000 - 025 - E	25	0.98	145	5.71	120	4.72			1324	2976	1559	3505	59	3.60	1,32	2,91	✓
H 1000 - 038 - D	H 1000 - 038 - E	38	1.50	171	6.73	133	5.24			1405	3159	1687	3793	79	4.81	1,43	3,15	✓
H 1000 - 050 - D	H 1000 - 050 - E	50	1.97	195	7.68	145	5.71			1455	3271	1767	3973	97	5.92	1,53	3,37	✓
H 1000 - 063 - D	H 1000 - 063 - E	63	2.48	221	8.74	158	6.22			1493	3357	1830	4113	117	7.13	1,64	3,62	✓
H 1000 - 075 - D	H 1000 - 075 - E	75	2.95	245	9.65	170	6.69			1520	3417	1873	4210	135	8.24	1,74	3,84	✓
H 1000 - 080 - D	H 1000 - 080 - E	80	3.15	255	10.04	175	6.89			1529	3438	1888	4244	143	8.70	1,78	3,92	✓
H 1000 - 100 - D	H 1000 - 100 - E	100	3.94	295	11.61	195	7.68			1559	3504	1937	4354	173	10.56	1,96	4.32	✓
H 1000 - 125 - D	H 1000 - 125 - E	125	4.92	345	13.58	220	8.66			1585	3562	1979	4450	211	12.88	2,17	4.78	✓
H 1000 - 150 - D	H 1000 - 150 - E	150	5.91	395	15.55	245	9.65			1603	3604	2010	4519	249	15.20	2,38	5.25	✓
H 1000 - 160 - D	H 1000 - 160 - E	160	6.30	415	16.34	255	10.04			1609	3617	2020	4541	264	16.13	2,46	5.42	✓
H 1000 - 175 - D	H 1000 - 175 - E	175	6.89	445	17.52	270	10.63			1617	3635	2033	4570	287	17.52	2,59	5.71	✓
H 1000 - 200 - D	H 1000 - 200 - E	200	7.87	495	19.49	295	11.61			1627	3659	2051	4610	325	19.84	2,79	6.15	✓
H 1000 - 250 - D	H 1000 - 250 - E	250	9.84	595	23.43	345	13.58			1643	3694	2077	4669	401	24.48	3,21	7.08	✓
H 1000 - 300 - D	H 1000 - 300 - E	300	11.81	695	27.36	395	15.55			1654	3718	2095	4710	477	29.13	3,63	8.00	✓

♦ Disposable

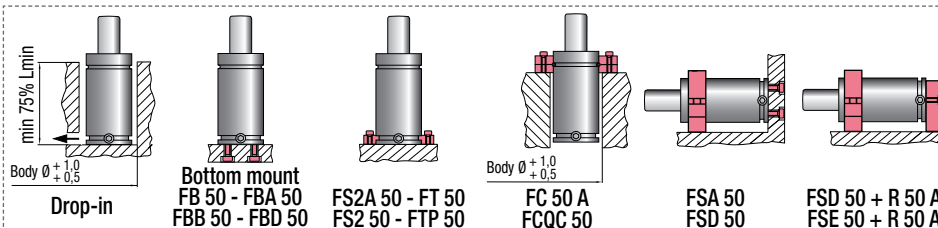

## HOW TO ORDER

p. 135

## INSTALLATION GUIDELINE

p. 205