



OSAS + OSM = OVER STROKE ACTIVE SAFETY + OVER STROKE MARKER



HIGH TEMP.

ACTIVE SAFETY



OSAS



USAS



OPAS

Il nuovo codice sarà fornito solo ad esaurimento del vecchio
The new code will be supplied only when the old will be out of stock

Der neue Kode wird nur angegeben, wenn der alte nicht mehr lieferbar ist

Le nouveau code sera fourni uniquement lorsque le vieux stock sera écoulé

El nuevo código será suministrado sólo cuando se agoten las existencias del antiguo

O novo código irá ser fornecido apenas quando o antigo esgotar stock

easu MANIPOL p. 247

* F_{1i} = Isothermal end force at 100% Cu p. 16

** F_{1p} = Polytropic end force at 100% Cu

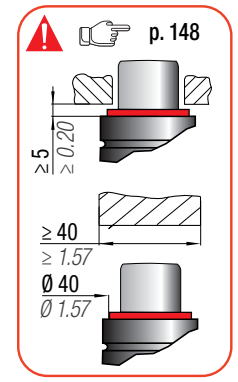
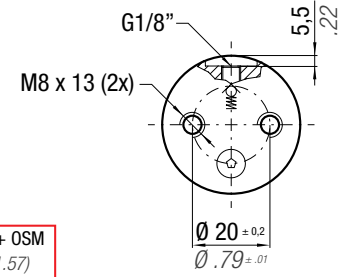
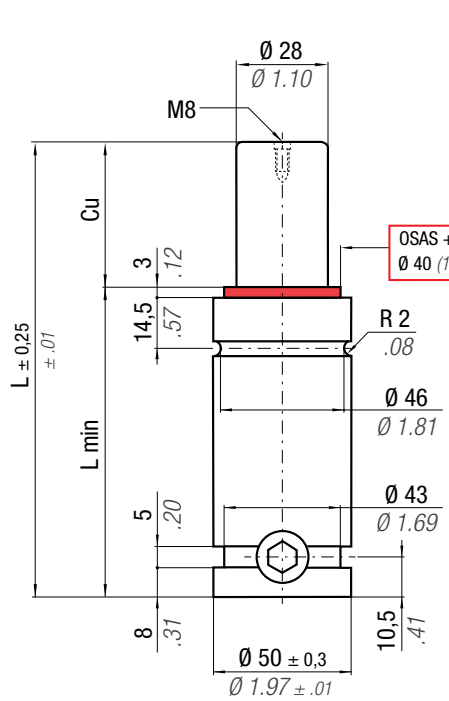

N ₂	80 - 100 °C 176 - 212 °F	ΔP ± 0,33 %/°C	P max 125 bar 1813 psi	P min 20 bar 290 psi	S 6,15 cm ² 0,953 in ²	SPM ~ 5 - 20	Max Speed 1 m/s 39.4 in/s	Maintenance kit 39BMHT01000A
----------------	-----------------------------	---------------------------	------------------------------	----------------------------	----------------------------------------------------	-----------------	---------------------------------	---------------------------------

CODE PHASING OUT from 04/2021	NEW	Cu		L		L min		F ₀		F _{1i} *		F _{1p} **		V ₀		PED 2014/68/EU		
		mm	inch	mm	inch	mm	inch	daN	lb	daN	lb	daN	lb	cm ³	in ³		~Kg	~lb
HT 1000-013-A-T1	HT 1000-013-B-T1	13	0.50	120,7	4.74	107,7	4.24	770	1731	1252	2814	1435	3225	40	2.47	1,21	2.67	✓
HT 1000-025-A-T1	HT 1000-025-B-T1	25	0.98	145	5.71	120	4.72			1373	3088	1632	3668	59	3.60	1,32	2.91	✓
HT 1000-038-A-T1	HT 1000-038-B-T1	38	1.50	171	6.73	133	5.24			1454	3269	1766	3970	79	4.81	1,43	3.15	✓
HT 1000-050-A-T1	HT 1000-050-B-T1	50	1.97	195	7.68	145	5.71			1503	3380	1850	4158	97	5.92	1,53	3.37	✓
HT 1000-063-A-T1	HT 1000-063-B-T1	63	2.48	221	8.74	158	6.22			1542	3465	1915	4305	117	7.13	1,64	3.62	✓
HT 1000-075-A-T1	HT 1000-075-B-T1	75	2.95	245	9.65	170	6.69			1568	3525	1960	4407	135	8.24	1,74	3.84	✓
HT 1000-080-A-T1	HT 1000-080-B-T1	80	3.15	255	10.04	175	6.89			1577	3545	1976	4442	143	8.70	1,78	3.92	✓
HT 1000-100-A-T1	HT 1000-100-B-T1	100	3.94	295	11.61	195	7.68			1606	3611	2027	4557	173	10.56	1,96	4.32	✓
HT 1000-125-A-T1	HT 1000-125-B-T1	125	4.92	345	13.58	220	8.66			1632	3668	2072	4657	211	12.88	2,17	4.78	✓
HT 1000-150-A-T1	HT 1000-150-B-T1	150	5.91	395	15.55	245	9.65			1650	3709	2104	4729	249	15.20	2,38	5.25	✓
HT 1000-160-A-T1	HT 1000-160-B-T1	160	6.30	415	16.34	255	10.04			1656	3722	2114	4753	264	16.13	2,46	5.42	✓
HT 1000-175-A-T1	HT 1000-175-B-T1	175	6.89	445	17.52	270	10.63			1663	3739	2128	4783	287	17.52	2,59	5.71	✓
HT 1000-200-A-T1	HT 1000-200-B-T1	200	7.87	495	19.49	295	11.61			1674	3763	2146	4825	325	19.84	2,79	6.15	✓
HT 1000-250-A-T1	HT 1000-250-B-T1	250	9.84	595	23.43	345	13.58			1689	3797	2174	4887	401	24.48	3,21	7.08	✓
HT 1000-300-A-T1	HT 1000-300-B-T1	300	11.81	695	27.36	395	15.55			1700	3821	2193	4929	477	29.13	3,63	8.00	✓

◆ Disposable

End force at 100°C / 212°F

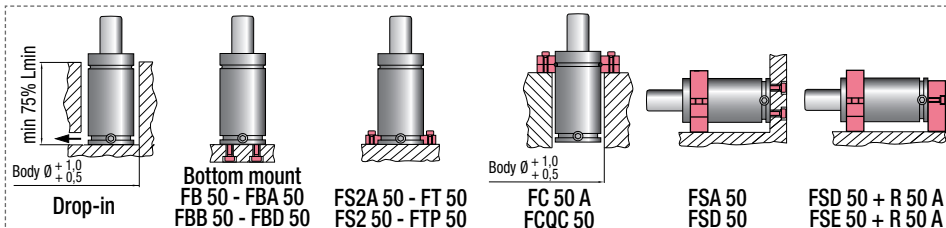

HOW TO ORDER

p. 149

INSTALLATION GUIDELINE

p. 205