

LINKED SYSTEM SELECTION

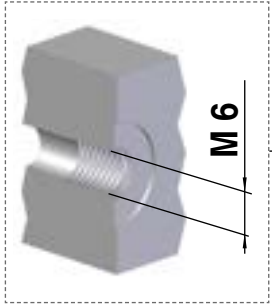

FLEXFLOW - CONNECTIONS
S12,65x1,5

TMA

Low gas flow

MICRO - CONNECTIONS
M8x1

TSM

Low gas flow

JIC 37° - CONNECTIONS
7/16"-20 UNF

TNC

High gas flow

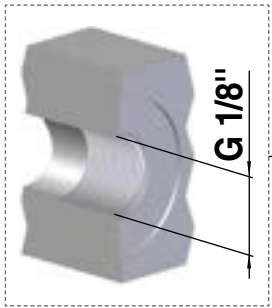

ORFS - CONNECTIONS
9/16"-18 UNF

HY 400

High gas flow

EO - 24° - CONNECTIONS
M12x1,5

HY 500

High gas flow

IT

- Pressa trasportabile con pompa pneumatica idraulica
- Idonea per raccordi dritti, 45° e 90°

EN

- Transportable press with hydraulic manual pump
- Suitable for straight, 45° and 90° fittings

DE

- Transportable Presse mit manueller Hydraulikpumpe
- Geeignet für gerade, 45° und 90° Anschlüsse

FR

- Presse transportable avec pompe oléodynamique manuelle
- Utilisable avec raccords droits, 45° et 90°

ES

- Prensa transportable con bomba oleodinámica manual
- Puede ser utilizada con tuberías derechas, 45° y 90°

PT

- Prensa transportável com bomba hidráulica manual
- Pode ser usado com tubos retos, 45° e 90°

code 39PR06



code 58UT022A (included)



IT Utensile rimuovi morsetti con calamita
EN Magnet tool to remove pressing jaws
DE Magnetwerkzeug für die Entfernung von Pressbacken
FR Outil magnétique pour enlever les mâchoires de pressage
ES Herramienta magnética para sacar las mordazas de la prensa
PT Ferramenta magnética para remover os mordentes de prensar

code 58UT001A (optional)



IT Forbice taglia tubo
EN Scissor for hose
DE Schlauchschneideschere
FR Ciseaux coupe-tube
ES Tijeras cortatubos
PT Tesouras corta tubos

code 58UT023A (optional)



IT Lampada led con magnete
EN LED Light with magnet
DE LED-Lampe mit Magnet
FR Lampe à LED magnétique
ES Lámpara LED con imán
PT Lâmpada LED com íman

AIR		L x P x H	Kg	°F °C
7 bar 110 psi	100 TON 110 US TON	380 x 430 x 400 mm 15 x 17 x 16 inch	38 kg 84 lb	-5 ÷ 40 °C 23 ÷ 104 °F

CONNECTIONS	ORFS "TSM" HOSE Ø 5,5 p. 288	Micro 32° - JIC 37° "TSM" HOSE Ø 5,5 p. 272 - 273	FlexFlow "TMA" HOSE Ø 5,1 p. 275	JIC 37° "TNB" HOSE Ø 8 p. 273	EO 24° "HY 500" HOSE Ø 11 p. 268	ORFS "HY 400" HOSE Ø 12,7 p. 284
PRESSING JAWS	code 39MTR10 (optional) 	code 39MTR11 (optional) 	code 39MTR12 (optional) 	code 39MTR13 (optional) 		

Ordering example: **39PR06A + 39MTR11** | Pressing jaws for Jic 37° "TNB" HOSE Ø 8,1

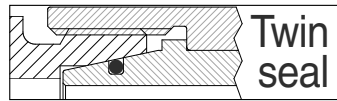

code TSM8...

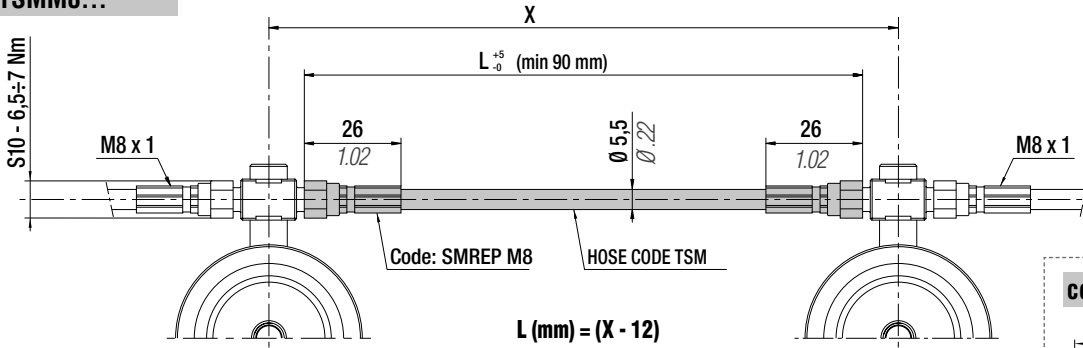

L = 5 mm upward increase - Example (TSM8 090 mm; TSM8 100 mm ...)

code TSM8...-1

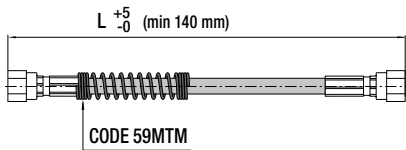

code TSM8...-2

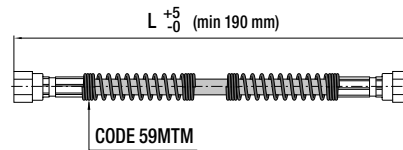

code: 59MTM

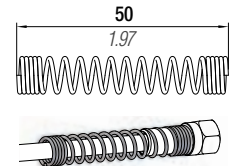

Protezione antipiega
Anti-kink protection
Knickschutzwendel
Protection anti-croquage
Protección anti-pleguez
Proteção anti-dobra

code: 36FF06A

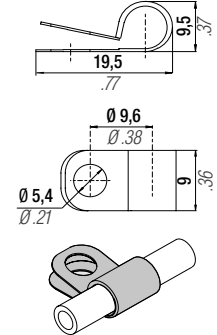

Technical data				
"L" min	See each type	3.54 in	Volume	3 ml/metre
Operation pressure	630 bar	9135 psi	Dimension	5/64" (external Ø 5,5 mm)
Burst Pressure	1890 bar at 20°C	27400 psi at 68°F	Material	Thermoplastic
R (bending radius)	20 mm	0.79 in	Standard	-
Operation temp.	-40 +100°C	-38 +212°F	Outer casing	Perforated



Lunghezza standard (mm) inclusive di n.2 raccordi SMREP M8
Standard lengths (mm) inclusive of no. 2 connections SMREP M8
Standard-Länge (mm) einsch. 2 SMREP-Anschlüssen M8

Longueur standard (mm) comprenant 2 raccords SMREP M8
Longitud estándar (mm) con 2 racores incluidos SMREP M8
Comprimento standard (mm) incluindo nas 2 ligações SMREP M8

CONNECTIONS

MICRO 32°

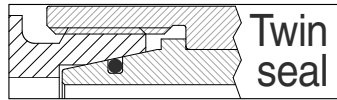

Blocchetto tubo-cilindro - Hose-cylinder block - Block, bestehend aus Schlauch-Zylinder - Bloc tube- cylindre - Bloque tubo-cilindro - Bloqueio do tubo-cilindro

code BDSM01

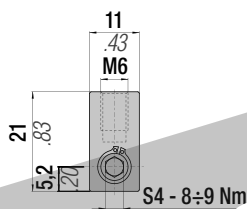

code BDSM02

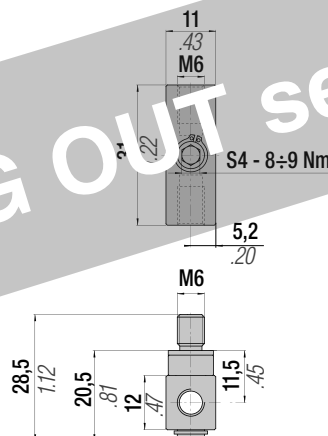

code BDSM02-45

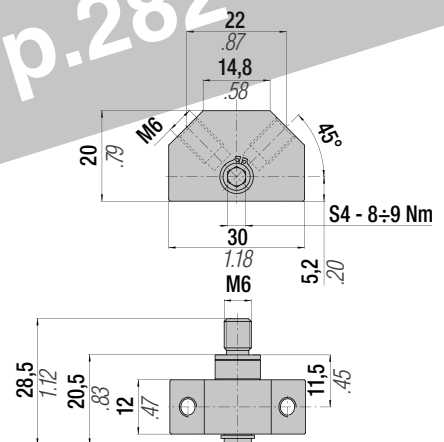

All dimensions in mm/inch

code TSM01A...

code: 36FF06A

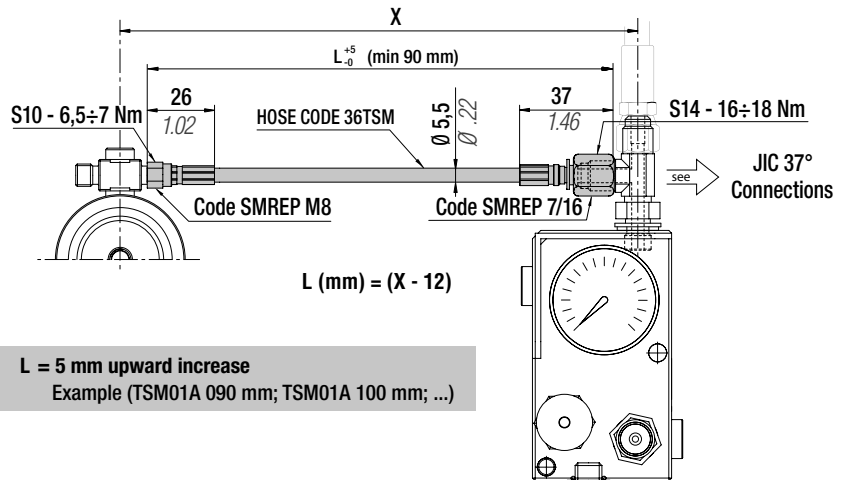
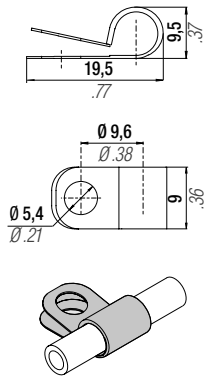

Technical data				
"L" min	See each type	3.54 in	Volume	3 ml/metre
Operation pressure	630 bar	9135 psi	Dimension	5/64" (external ø 5,5 mm)
Burst Pressure	1890 bar at 20°C	27400 psi at 68°F	Material	Thermoplastic
R (bending radius)	20 mm	0.79 in	Standard	-
Operation temp.	-40 +100°C	-38 +212°F	Outer casing	Perforated



Lunghezze standard (mm) inclusive di n.2 raccordi SMREP M8
Standard lengths (mm) inclusive of no. 2 connections SMREP M8
Standard-Länge (mm) einsch. 2 SMREP-Anschlüssen M8

Longueur standard (mm) comprenant 2 raccords SMREP M8
Longitud estándar (mm) con 2 racores incluidos SMREP M8
Comprimento standard (mm) incluído nas 2 ligações SMREP M8

MICRO 32° and FLEXFLOW Hose Ø 5,1 mm

code 36TMA01A...

code: 36FF06A

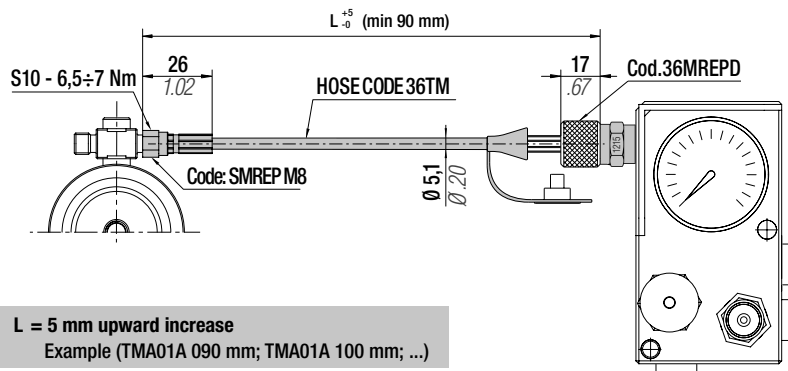
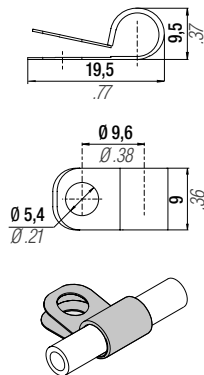

Technical data				
"L" min	See each type	-	Volume	3 ml/metre
Operation pressure	630 bar	9135 psi	Dimension hose	5/64" (external ø 5,1 mm)
Burst Pressure	1950 bar at 20°C	28275 psi at 68°F	Material hose	Polyamide
R (bending radius)	20 mm	0.79 in	Standard	-
Operation temp.	-20 +100°C	-2 +212°F	Outer casing hose	Perforated



Lunghezze standard (mm) inclusive di n.2 raccordi e tappi
Standard lengths (mm) inclusive of no.2 connections and plugs
Standard-Länge (mm) einsch.2 und Stopfen Anschlüssen

Longueur standard (mm) comprenant 2 raccords et bouchons
Longitud estándar (mm) con 2 racores incluidos y tapones
Comprimento standard (mm) incluído nas 2 ligações e tampões

All dimensions in mm/inch

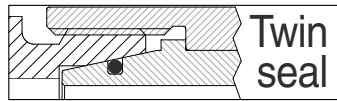

Raccordi tubo-cilindro/pannello - Hose-cylinder/panel connections - Anschlüsse zwischen schlauch und Zylinder/Kontrollarmatur -
 Raccords tuyau-cylindre/tableau - Racores manguera-cilindros/panel - Racord tubo-cilindro/painel

code MT

(only M 50, M70, M90, M90 TBM, M90 TEM, M90 TBI, M200 RV 170 - 320 rev.C)

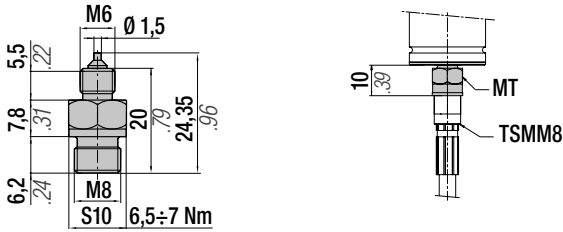

code MB

(only M 50, M70, M90, M90 TBM, M90 TEM, M90 TBI, M200 RV 170 - 320 rev.C)

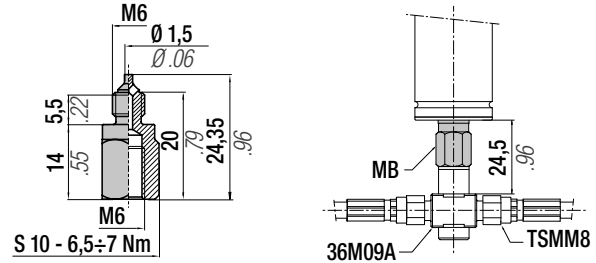

code RSMTCD

S 10 - 6.5±7 Nm

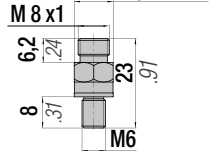

code 36M08B

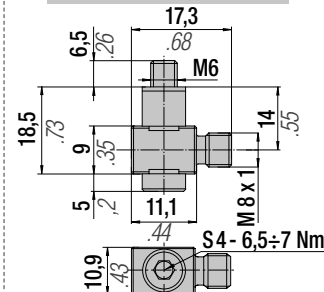

code 36M09B

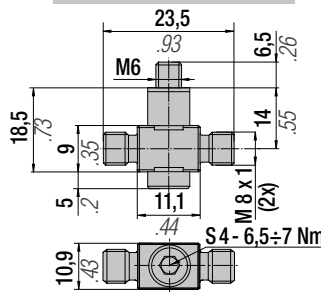

code 36M10C

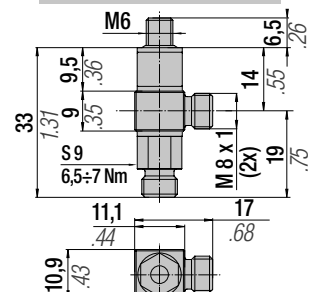

code 36M11C

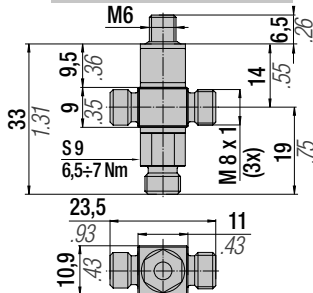

code RSMPD

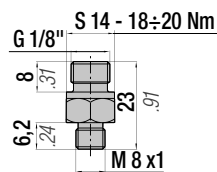

code 36M03A

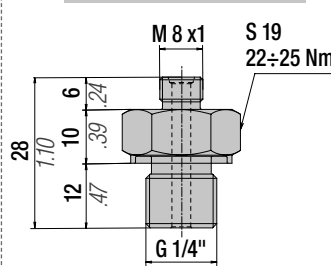

code 36M22A

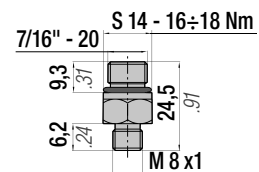

Raccordi di derivazione - Offtake connections - Anschlußstutzen - Raccords de dérivation - Racores de derivación - Racord de derivação

code 36M02A

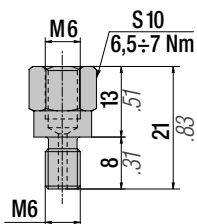

code 36M04A

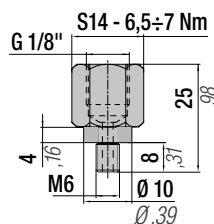

code 36MTC

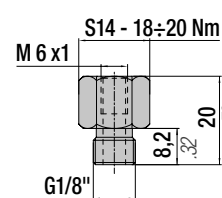

code 36MTR

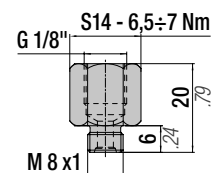

code 36M01A

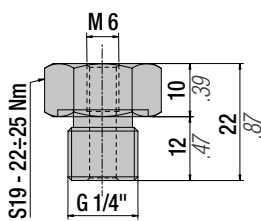

code 36M12A

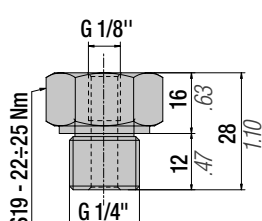

code 36M21A

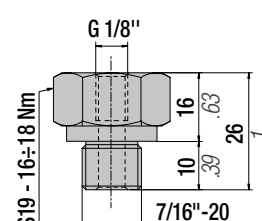

All dimensions in mm/inch

Raccordi tubo-tubo - Hose-hose connections - Anschlüsse zwischen Schlauch und Schlauch - Raccords tuyau-tuyau - Racores tubo-tubo - Racord tubo-tubo

code 36MTTD

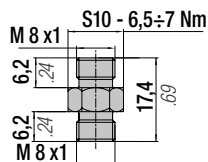

code 36RTTJM

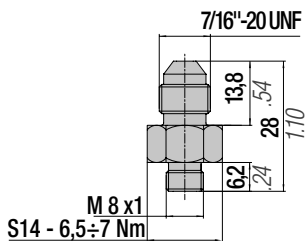

code 36M05A

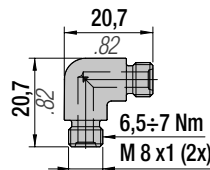

code 36M06A

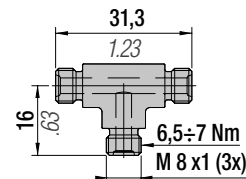

code 36M07A

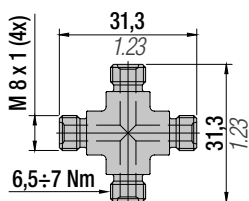

MICRO 32° HEAVY DUTY STAINLESS STEEL CONNECTIONS

Raccordi tubo-cilindro/pannello - Hose-cylinder/panel connections - Anschlüsse zwischen schlauch und Zylinder/Kontrollarmatur - Raccords tuyau-cylindre/tableau - Conexiones sistema de cilindros/panel - Racord tubo-cilindro/panel

code 36M15A

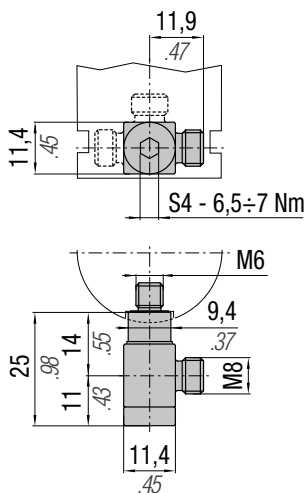

code 36M16A

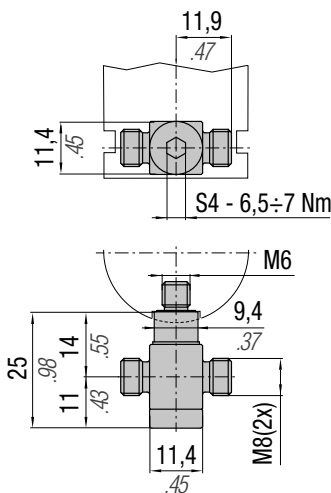

code 36M17A

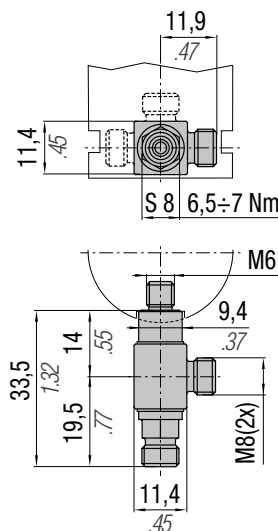

code 36M18A

