



SW

ACTIVE SAFETY



OSAS



USAS



OPAS

Il nuovo codice sarà fornito solo ad esaurimento del vecchio

The new code will be supplied only when the old will be out of stock

Der neue Kode wird nur angegeben, wenn der alte nicht mehr lieferbar ist

Le nouveau code sera fourni uniquement lorsque le vieux stock sera écoulé

El nuevo código será suministrado sólo cuando se agoten las existencias del antiguo

O novo código irá ser fornecido apenas quando o antigo esgotar stock



p. 247

* $F_{1i} =$

Isothermal end force at 100% Cu

** $F_{1p} =$

Polytrophic end force at 100% Cu

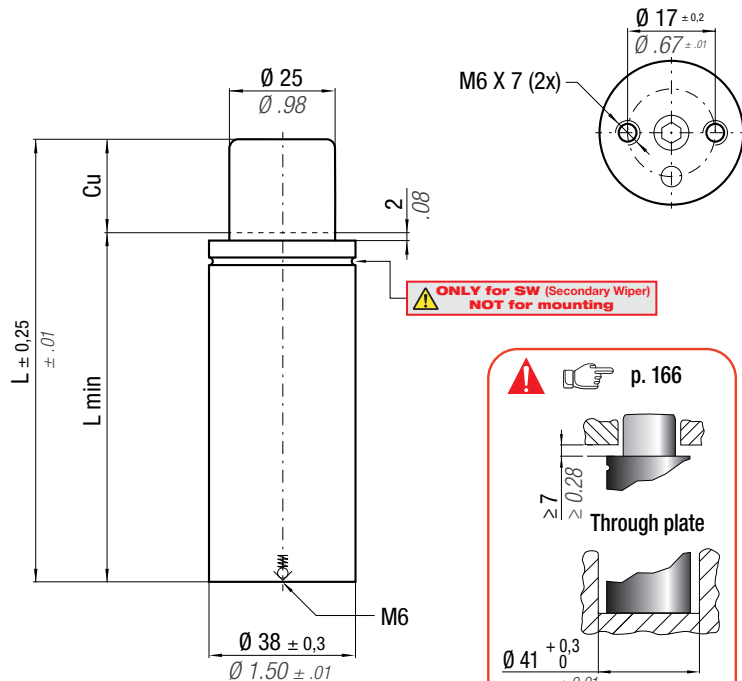

N₂	0 - 80 °C 32 - 176 °F	ΔP ± 0,33 %/°C	P max 200 bar 2900 psi	P min 20 bar 290 psi	S 4,91 cm ² 0,761 in ²	SPM ~ 40 - 80 (at 20°C)	Max Speed 1,6 m/s 62,9 in/s	Maintenance kit 39BMML01000C
----------------------	--------------------------	--------------------------	-------------------------------------	-----------------------------------	---	--------------------------------------	--	--

CODE PHASING OUT from 05/2019	NEW	Cu		L		L min		F ₀		F _{1i} *		F _{1p} **		V ₀		~Kg	~lb	PED 2014/68/EU
		mm	inch	mm	inch	mm	inch	daN	lb	daN	lb	daN	lb	cm ³	in ³			
ML 1000 - 010 - C	ML 1000 - 010 - D	10	0.39	75	2.95	65	2.56	980	2203	1377	3096	1550	3485	21,6	1.32	0,37	0,82	✓
ML 1000 - 015 - C	ML 1000 - 015 - D	15	0.59	85	3.35	70	2.76											
ML 1000 - 025 - C	ML 1000 - 025 - D	25	0.98	105	4.13	80	3.15	200 bar	2900 psi	1700	3822	1999	4494	35,8	2.18	0,45	0,99	✓
ML 1000 - 038 - C	ML 1000 - 038 - D	38	1.50	135	5.31	97	3.82											
ML 1000 - 050 - C	ML 1000 - 050 - D	50	1.97	160	6.30	110	4.33	+20 °C	+68 °F	1871	4206	2244	5045	63,1	3.85	0,60	1.32	✓
ML 1000 - 063 - C	ML 1000 - 063 - D	63	2.48	205	8.07	142	5.59											
ML 1000 - 080 - C	ML 1000 - 080 - D	80	3.15	240	9.45	160	6.30	1805	4058	2149	4830	105,6	6.44	0,82	1,81	✓		

KIT FOR LINKING

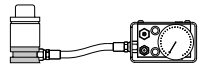

- code: 39FML01000D
- Seal (1x)
 - Washer (4x)
 - Screw (2x)
 - Bottom base (1x)
 - Valve (1x)
 - Instructions

Sostituire ogni 1.000.000 di cicli. Replace every 1 million cycles. Nach 1 Mio. Hübe austauschen. Reemplazar a cada 1 millón de ciclos. Substituir a cada 1 milhão de ciclos.

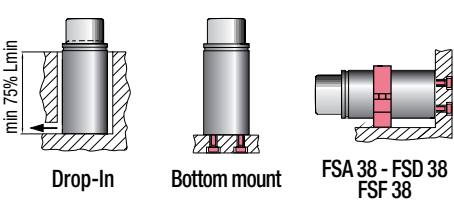
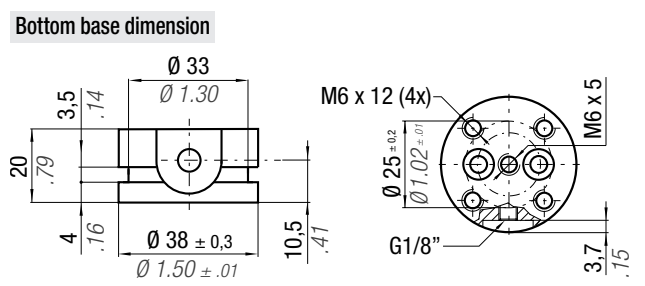

HOW TO ORDER

p. 167

INSTALLATION GUIDELINE

p. 205