



SW

ACTIVE SAFETY



OSAS



USAS

* $F_{1i} =$

Isothermal end force at 100% Cu



p. 16



** $F_{1p} =$

Polytropic end force at 100% Cu

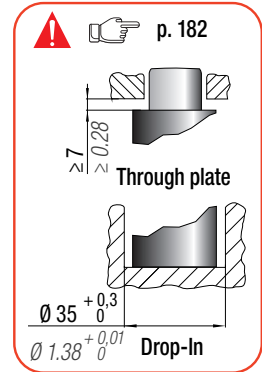
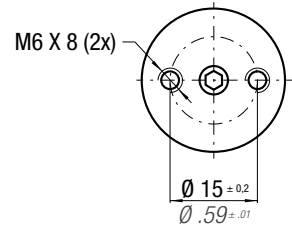
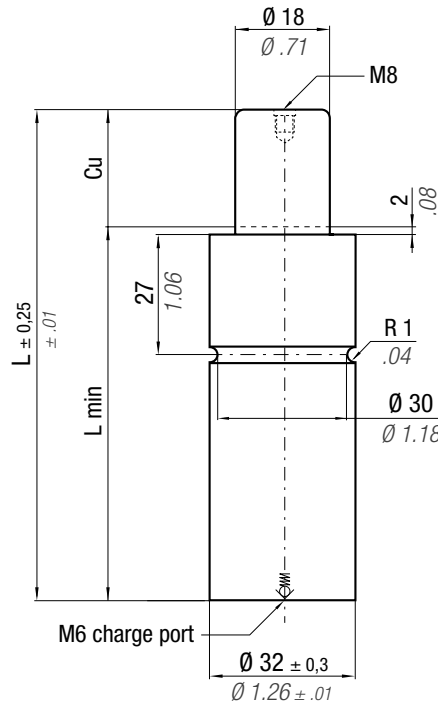

CODE	N ₂	0 - 80 °C 32 - 176 °F	ΔP ± 0,33 %/°C	P max 197 bar 2857 psi	P min 20 bar 290 psi	S 2,54 cm ² 0,394 in ²	SPM ~ 40 - 80 (at 20°C)	Max Speed 1,6 m/s 62,9 in/s	Maintenance kit Disposable	PED 2014/68/EU	Cu		L		L min		F ₀		F _{1i} *		F _{1p} **		V ₀					
											mm	inch	mm	inch	mm	inch	daN	lb	daN	lb	daN	lb	cm ³	in ³	~Kg	~lb		
MP 500 - 010 - A											10	0.39	75	2.95	65	2.56	500 ± 5%	1124	197 bar 2857 psi	714	1605	798	798	10,7	0.65	0,29	0,64	✓
MP 500 - 015 - A										15	0.59	85	3.35	70	2.76	770				1731	873	873	13,6	0.83	0,31	0,68	✓	
MP 500 - 020 - A										20	0.79	95	3.74	75	2.95	809				1819	928	928	16,5	1.01	0,33	0,73	✓	
MP 500 - 025 - A										25	0.98	105	4.13	80	3.15	839				1886	970	970	19,5	1.19	0,34	0,75	✓	
MP 500 - 032 - A										32	1.26	120	4.72	88	3.46	859				1931	997	997	24,1	1.47	0,37	0,82	✓	
MP 500 - 038 - A										38	1.50	135	5.31	97	3.82	849				1909	984	984	29,1	1.78	0,40	0,88	✓	
MP 500 - 045 - A										45	1.77	150	5.91	105	4.13	862				1938	1002	1002	33,6	2.05	0,43	0,95	✓	
MP 500 - 050 - A										50	1.97	160	6.30	110	4.33	875				1967	1020	1020	36,6	2.23	0,45	0,99	✓	
MP 500 - 056 - A										56	2.20	175	6.89	119	4.69	866				1947	1008	1008	41,6	2.54	0,48	1.06	✓	
MP 500 - 063 - A										63	2.48	195	7.68	132	5.20	844				1897	977	977	48,6	2.96	0,52	1.15	✓	
MP 500 - 080 - A										80	3.15	230	9.06	150	5.91	869	1954	1012	1012	59,1	3.61	0,59	1.30	✓				

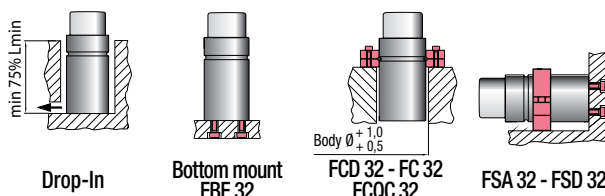

HOW TO ORDER

p. 183

INSTALLATION GUIDELINE

p. 205