

## ACTIVE SAFETY



OSAS



USAS

\*  $F_{1i}$  =  
Isothermal  
end force  
at 100% Cu



p. 16



\*\*  $F_{1p}$  =  
Polytrophic  
end force  
at 100% Cu

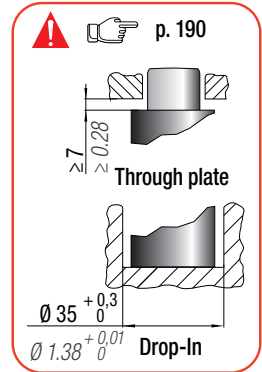
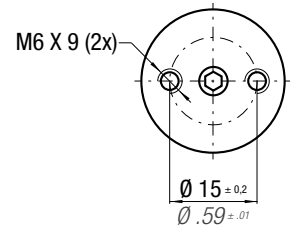
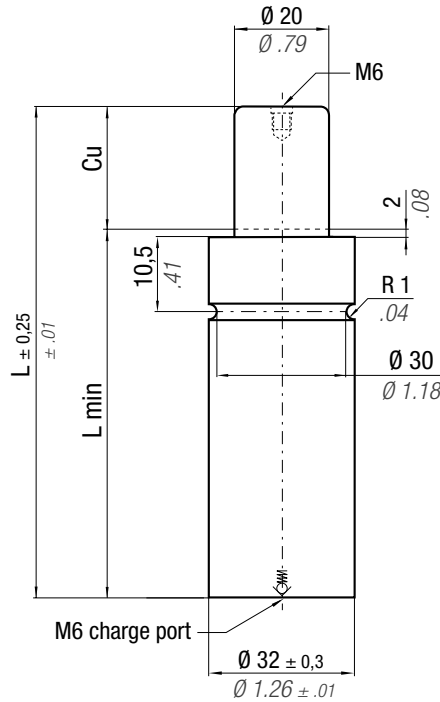

CODE	Cu	L	L min	F <sub>0</sub>		F <sub>1i</sub> *		F <sub>1p</sub> **		V <sub>0</sub>		Maintenance kit		
				Initial force	End force *	End force **	cm <sup>3</sup>	in <sup>3</sup>	~Kg	~lb				
MQ 700 - 010 - A	10	75	65	660 ± 5%	1484	1020	2293	1158	2603	11,3	0,69	0,29	0,64	✓
MQ 700 - 015 - A	15	85	70			1120	2517	1293	2907	14,4	0,88	0,31	0,68	✓
MQ 700 - 020 - A	20	95	75			1193	2683	1395	3135	17,5	1,07	0,33	0,73	✓
MQ 700 - 025 - A	25	105	80			1250	2810	1473	3312	20,6	1,26	0,35	0,77	✓
MQ 700 - 032 - A	32	120	88			1288	2896	1527	3432	25,5	1,56	0,38	0,84	✓
MQ 700 - 038 - A	38	135	97			1272	2861	1505	3383	30,7	1,87	0,41	0,90	✓
MQ 700 - 045 - A	45	150	105			1297	2916	1539	3461	35,6	2,17	0,44	0,97	✓
MQ 700 - 050 - A	50	160	110			1322	2972	1575	3540	38,7	2,36	0,46	1,01	✓
MQ 700 - 056 - A	56	175	119			1307	2937	1553	3490	43,9	2,68	0,49	1,08	✓
MQ 700 - 063 - A	63	195	132			1266	2846	1496	3363	51,2	3,12	0,53	1,17	✓
MQ 700 - 080 - A	80	230	150	1314	2954	1563	3515	62,3	3,80	0,60	1,32	✓		

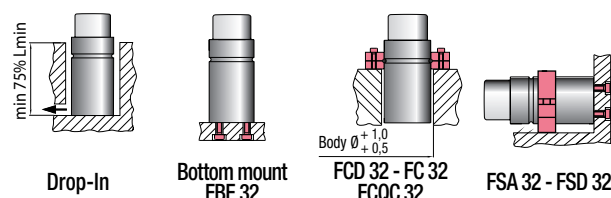

## HOW TO ORDER

p. 191

## INSTALLATION GUIDELINE

p. 205