





$\varnothing 32$  | Massima forza, tenuta stelo - Maximum force, rod seal - Maximale Kraft, Kolbenstange dichtung  
 Forces maximale, joint de tige - Máxima fuerza, estanqueidad vástago - Força máxima, estanquidade na haste

<b>SEALING</b>	ROD SEAL
<b>DESIGN</b>	BOTTOM BASE - BODY DESIGN

<b>1</b>	Retaining ring	<b>5</b>	Valve	<b>9</b>	Back-up ring
<b>2</b>	Dual ring seal	<b>6</b>	Body	<b>10</b>	Rod wiper
<b>3</b>	Bottom base	<b>7</b>	Guide ring	<b>11</b>	Rod (nitrited superfinished)
<b>4</b>	Plug	<b>8</b>	Rod seal		

# RANGE CHART

Model	Body Ø		Stroke Cu		Initial force F0						
	mm	inch	mm	inch	daN	lb	OSAS	USAS	OPAS	SKUDO	SW
MQ 700	32	1.26	10 - 80	0.39 - 3.15	660	1484	✓	✓	-	-	-

✓ Built-in as standard      ✓ Optional upon request

## HOW TO ORDER

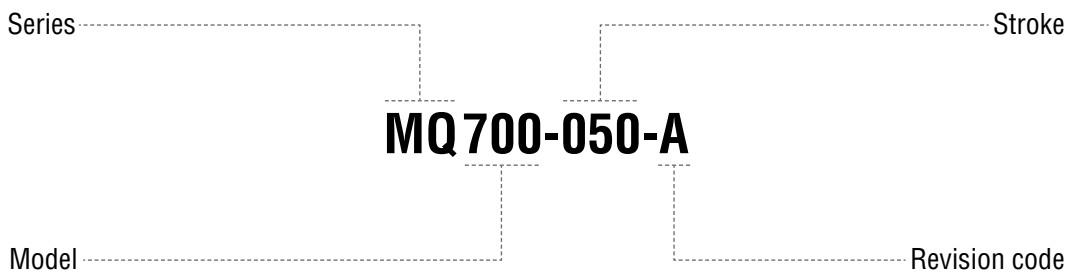

### Available version



**MQ 700-050-A**  
Standard code



Self contained

## ACTIVE SAFETY



OSAS



USAS

\*  $F_{1i} =$   
Isothermal  
end force  
at 100% Cu



p. 16



\*\*  $F_{1p} =$   
Polytrophic  
end force  
at 100% Cu

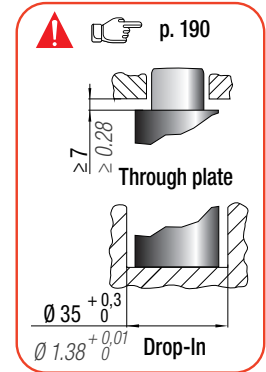
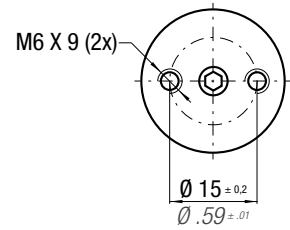
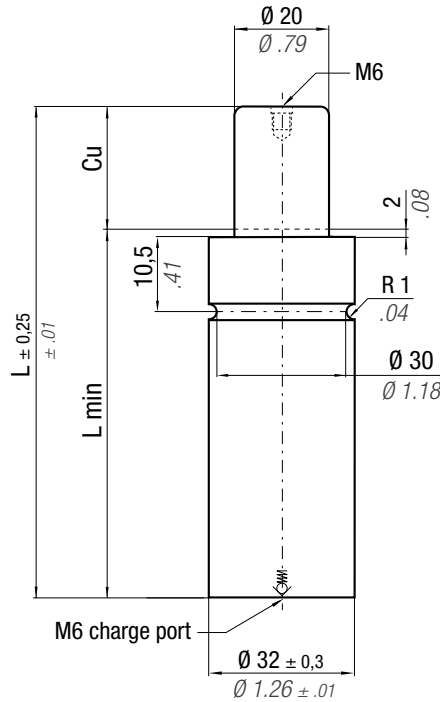

CODE	N <sub>2</sub>	0 - 80 °C 32 - 176 °F	ΔP ± 0,33 %/°C	P max 210 bar 3045 psi	P min 20 bar 290 psi	S 3,14 cm <sup>2</sup> 0,487 in <sup>2</sup>	SPM ~ 40 - 80 (at 20°C)	Max Speed 1,6 m/s 62.9 in/s	Maintenance kit Disposable	Cu	L	L min	F <sub>0</sub> Initial force		F <sub>1i</sub> * End force *		F <sub>1p</sub> ** End force **		V <sub>0</sub>		~Kg	~lb	PED 2014/68/EU	
													mm	inch	mm	inch	mm	inch	daN	lb				daN
MQ 700 - 010 - A										10	75	65	660 ± 5%	1484	210 bar 3045 psi	1020	2293	1158	2603	11,3	0,69	0,29	0,64	✓
MQ 700 - 015 - A									15	85	70	1120				2517	1293	2907	14,4	0,88	0,31	0,68	✓	
MQ 700 - 020 - A									20	95	75	1193				2683	1395	3135	17,5	1,07	0,33	0,73	✓	
MQ 700 - 025 - A									25	105	80	1250				2810	1473	3312	20,6	1,26	0,35	0,77	✓	
MQ 700 - 032 - A									32	120	88	1288				2896	1527	3432	25,5	1,56	0,38	0,84	✓	
MQ 700 - 038 - A									38	135	97	1272				2861	1505	3383	30,7	1,87	0,41	0,90	✓	
MQ 700 - 045 - A									45	150	105	1297				2916	1539	3461	35,6	2,17	0,44	0,97	✓	
MQ 700 - 050 - A									50	160	110	1322				2972	1575	3540	38,7	2,36	0,46	1,01	✓	
MQ 700 - 056 - A									56	175	119	1307				2937	1553	3490	43,9	2,68	0,49	1,08	✓	
MQ 700 - 063 - A									63	195	132	1266				2846	1496	3363	51,2	3,12	0,53	1,17	✓	
MQ 700 - 080 - A									80	315	230	1314	2954	1563	3515	62,3	3,80	0,60	1,32	✓				

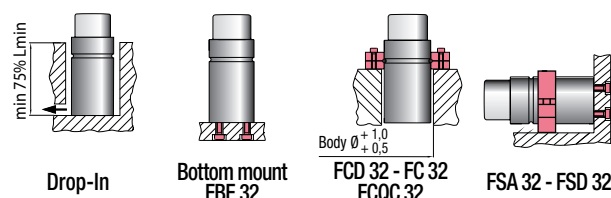

## HOW TO ORDER

p. 191

## INSTALLATION GUIDELINE

p. 205