

VDI 3004 90.25.97 (GM)	B2 4036 (BMW) 90.25.28 (GM)	075.90.40 (FCA) 39D 549 (VW)	W-DX35-60M (Ford)
---------------------------	--------------------------------	---------------------------------	-------------------

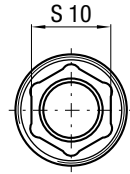

cod. 39CM01A  
(optional)

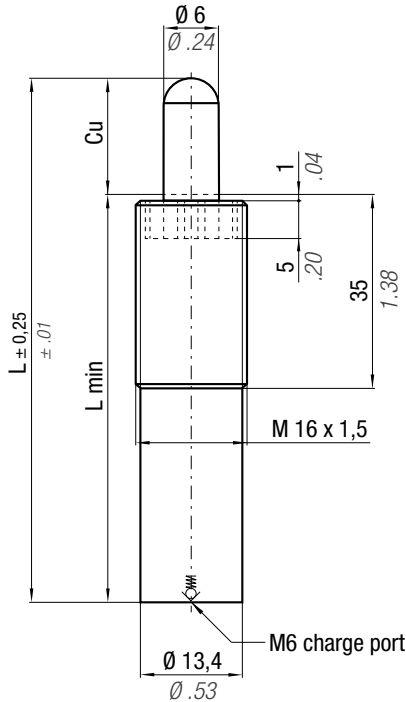
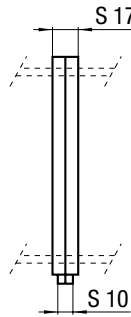

\*  $F_{1i} =$

Isothermal  
end force p. 16  
at 100% Cu

\*\*  $F_{1p} =$

Polytropic  
end force   
at 100% Cu

**ACTIVE  
SAFETY**



USAS

CODE	Cu		L		L min		~Kg		~lb		Force color code	P		F <sub>0</sub> Initial force ± 5%		F <sub>1i</sub> End force*	F <sub>1p</sub> End force**
	mm	inch	mm	inch	mm	inch			bar	psi		daN	lb	+20°C +68°F			
NG 16 x 1,5-010-A-...	10	0.39	80	3.15	70	2.76	0,05	0.11	✓								
NG 16 x 1,5-020-A-...	20	0.79	100	3.94	80	3.15	0,06	0.13	✓								
NG 16 x 1,5-030-A-...	30	1.18	120	4.72	90	3.54	0,07	0.15	✓	GR	20	290	6	13	1,41 x F <sub>0</sub>	1,72 x F <sub>0</sub>	
NG 16 x 1,5-040-A-...	40	1.57	140	5.51	100	3.94	0,07	0.15	✓	BU	40	580	11	25	1,41 x F <sub>0</sub>	1,72 x F <sub>0</sub>	
NG 16 x 1,5-050-A-...	50	1.97	160	6.30	110	4.33	0,08	0.18	✓	RD	75	1088	21	47	1,41 x F <sub>0</sub>	1,72 x F <sub>0</sub>	
NG 16 x 1,5-060-A-...	60	2.36	180	7.09	120	4.72	0,08	0.18	✓	YW	150	2175	42	94	1,41 x F <sub>0</sub>	1,72 x F <sub>0</sub>	
NG 16 x 1,5-070-A-...	70	2.76	200	7.87	130	5.12	0,09	0.20	✓	BK	10-150	145-2175	3-42	7-95	1,41 x F <sub>0</sub>	1,72 x F <sub>0</sub>	
NG 16 x 1,5-080-A-...	80	3.15	220	8.66	140	5.51	0,10	0.22	✓								
NG 16 x 1,5-100-A-...	100	3.94	260	10.24	160	6.30	0,11	0.24	✓								

P = nominal charging pressure

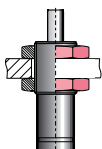

DM 16

**HOW TO ORDER**

p. 31

**INSTALLATION GUIDELINE**

p. 205