

# NG 24 x 1.5

VDI 3004 90.25.96 (GM)	075.90.40 (FCA) 39D 549 (VW)	W-DX35-60M (Ford)	90.25.95 (GM)
---------------------------	---------------------------------	-------------------	---------------



## ACTIVE SAFETY



USAS



OPAS

\*  $F_{1i} =$

Isothermal  
end force  
at 100% Cu



p. 16



\*\*  $F_{1p} =$

Polytropic  
end force  
at 100% Cu

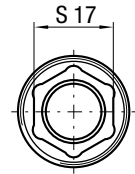
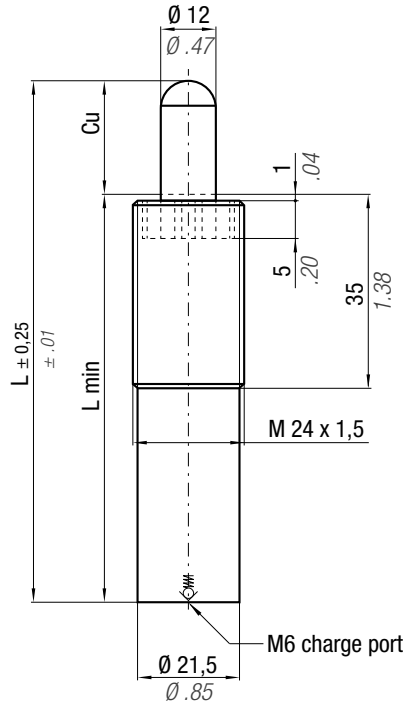

cod. 39CM01A  
(optional)

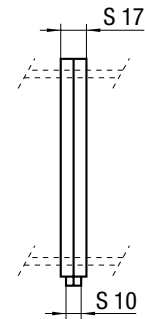

CODE	Cu		L		L min		~Kg		~lb	PED 2014/68/EU	Force color code	P		F <sub>0</sub> Initial force ± 5%		F <sub>1i</sub> End force*	F <sub>1p</sub> End force**
	mm	inch	mm	inch	mm	inch	bar	psi				daN	lb				
NG 24 x 1,5-010-A-...	10	0.39	80	3.15	70	2.76	0,15	0.33	✓		GR	20	290	23	52	1,57 x F <sub>0</sub>	2,01 x F <sub>0</sub>
NG 24 x 1,5-020-A-...	20	0.79	100	3.94	80	3.15	0,17	0.37	✓		BU	40	580	45	101	1,57 x F <sub>0</sub>	2,01 x F <sub>0</sub>
NG 24 x 1,5-030-A-...	30	1.18	120	4.72	90	3.54	0,19	0.42	✓		BR	60	870	67	151	1,57 x F <sub>0</sub>	2,01 x F <sub>0</sub>
NG 24 x 1,5-040-A-...	40	1.57	140	5.51	100	3.94	0,22	0.49	✓		RD	75	1088	85	191	1,57 x F <sub>0</sub>	2,01 x F <sub>0</sub>
NG 24 x 1,5-050-A-...	50	1.97	160	6.30	110	4.33	0,24	0.53	✓		YW	150	2175	170	382	1,57 x F <sub>0</sub>	2,01 x F <sub>0</sub>
NG 24 x 1,5-060-A-...	60	2.36	180	7.09	120	4.72	0,26	0.57	✓		BK	10-150	145-2175	11-170	25-382	1,57 x F <sub>0</sub>	2,01 x F <sub>0</sub>
NG 24 x 1,5-070-A-...	70	2.76	200	7.87	130	5.12	0,28	0.62	✓								
NG 24 x 1,5-080-A-...	80	3.15	220	8.66	140	5.51	0,29	0.64	✓								
NG 24 x 1,5-100-A-...	100	3.94	260	10.24	160	6.30	0,31	0.68	✓								

P = nominal charging pressure

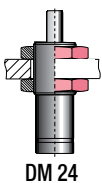

DM 24

## HOW TO ORDER

p. 31

## INSTALLATION GUIDELINE

p. 205