

FCA		

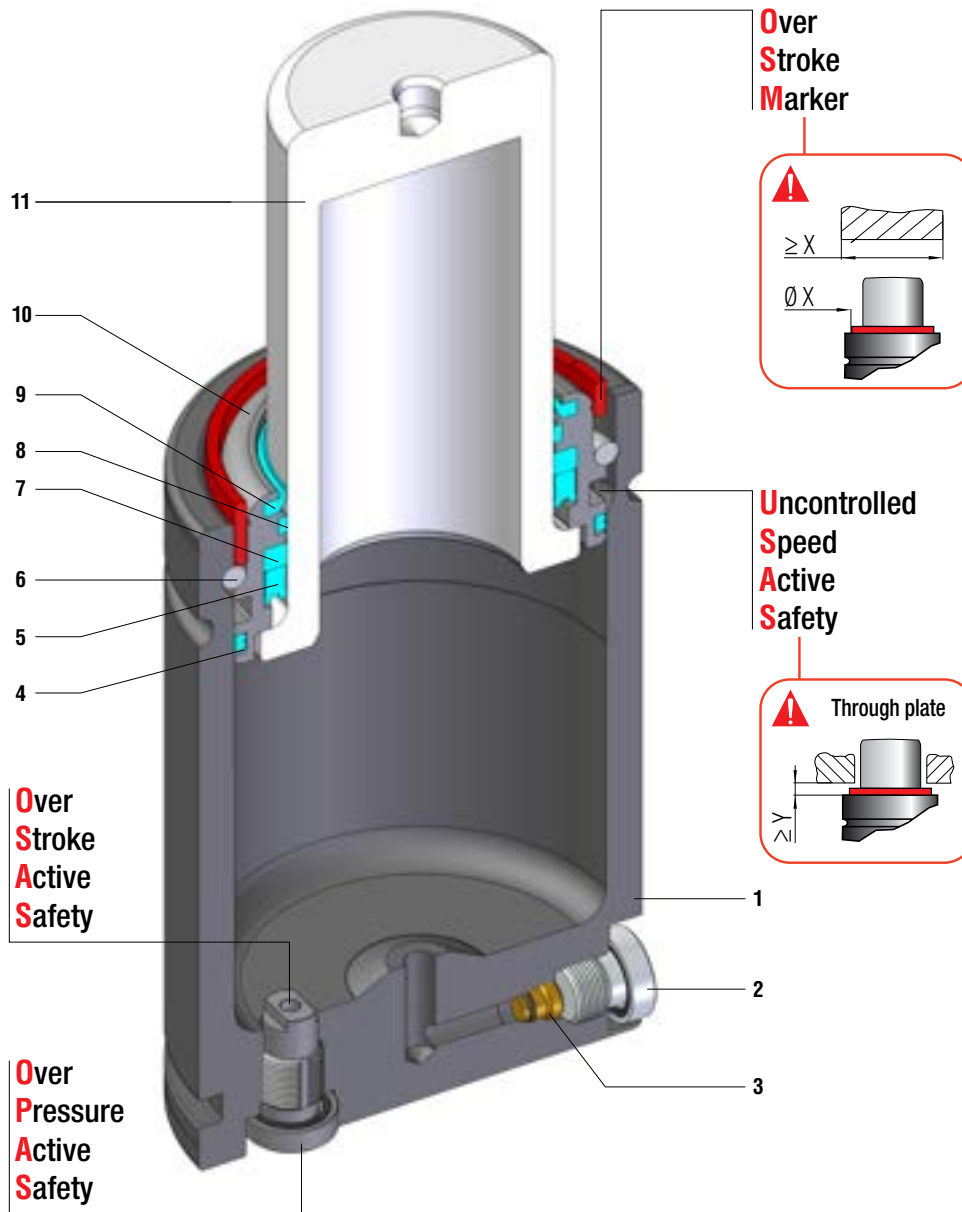

Minima altezza, massima forza, collegabili G1/8 - Minimum height, maximum force, hose cylinders with G1/8 charging port  
 Minimale Höhe, maximale Kraft, Gdf. mit G1/8 Öffnung verbindbar - Hauteur minimale, force maximale, cylindres raccordés avec trou G1/8 gaz  
 Mínima altura, máxima fuerza, cilindros conectados con agujero G1/8 gas - Altura mínima, força máxima, cilindros conectados com furo G1/8 gás

<b>SEALING</b>	ROD SEAL
<b>DESIGN</b>	BUSH - BODY DESIGN

<b>1</b>	Body	<b>5</b>	Rod seal	<b>9</b>	Rod wiper
<b>2</b>	Plug	<b>6</b>	Retaining ring	<b>10</b>	Bush
<b>3</b>	Valve	<b>7</b>	Back-up ring	<b>11</b>	Rod (nitrited superfinished)
<b>4</b>	Dual ring seal	<b>8</b>	Guide ring		

## RANGE CHART

Model	Body Ø		Stroke Cu		Initial force F0								
	mm	inch	mm	inch	daN	lb	OSAS	USAS	OPAS	SKUDO	SW		
RF 750	45	1.77	10 - 125	0.39 - 4.92	740	1664	✓	✓	✓	-	✓		
RF 1000	50	1.97	13 - 125	0.51 - 4.92	920	2068	✓	✓	✓	-	✓		
RF 1200	50	1.97	13 - 125	0.51 - 4.92	1060	2383	✓	✓	✓	-	✓		
RF 1500	63	2.48	13 - 125	0.51 - 4.92	1530	3440	✓	✓	✓	-	✓		
RF 2400	75	2.95	16 - 125	0.63 - 4.92	2385	5362	✓	✓	✓	-	✓		
	95	3.74	<b>RV series</b>									✓ Built-in as standard	✓ Optional upon request
	120	4.72											
	150	5.91											
	150	5.91											
	195	7.68											

## HOW TO ORDER

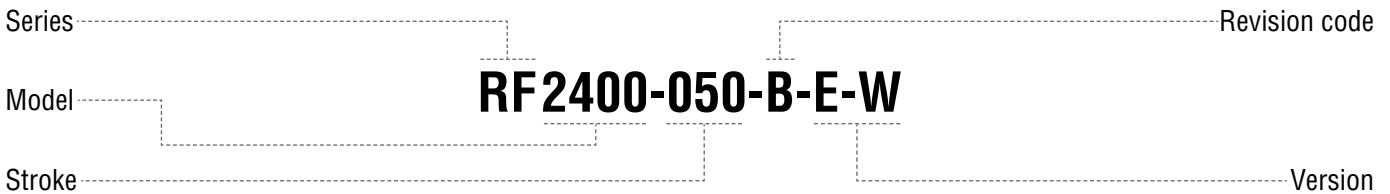

### Available versions

<b>RF 2400-050-B</b> Standard code	<b>RF 2400-050-B-W</b> Add "-W" to standard code	<b>RF 2400-050-B-N</b> Add "-N" to standard code	<b>RF 2400-050-B-N-W</b> Add "-N-W" to standard code	<b>RF 2400-050-B-E</b> Add "-E" to standard code	<b>RF 2400-050-B-E-W</b> Add "-E-W" to standard code
Self contained	Self contained +  Secondary wiper	Linkable	Linkable +  Secondary wiper	Easy Manifold	Easy Manifold +  Secondary wiper



**OSAS + OSM** = OVER STROKE ACTIVE SAFETY + OVER STROKE MARKER

## ACTIVE SAFETY



OSAS



USAS



OPAS

Il nuovo codice sarà fornito solo ad esaurimento del vecchio

The new code will be supplied only when the old will be out of stock

Der neue Kode wird nur angegeben, wenn der alte nicht mehr lieferbar ist

Le nouveau code sera fourni uniquement lorsque le vieux stock sera écoulé

El nuevo código será suministrado sólo cuando se agoten las existencias del antiguo

O novo código irá ser fornecido apenas quando o antigo esgotar stock

**easu** MANIPOL p. 247

\*  $F_{1i}$  = Isothermal end force at 100% Cu p. 16

\*\*  $F_{1p}$  = Polytrophic end force at 100% Cu

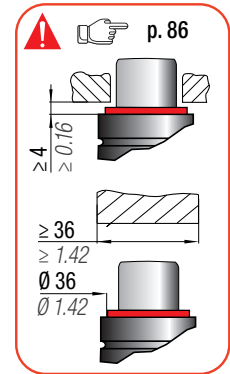
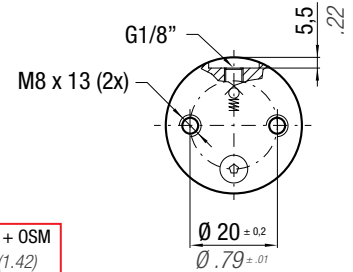
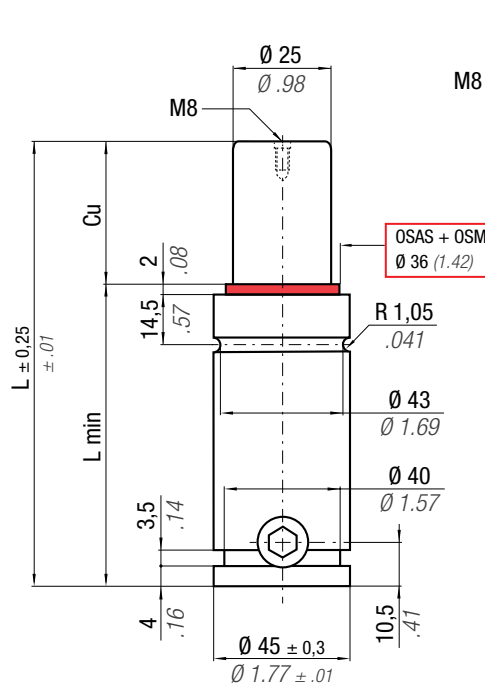

		$\Delta P$	<b>P max</b>	<b>P min</b>	<b>S</b>	<b>SPM</b>	<b>Max Speed</b>	<b>Maintenance kit</b>
N <sub>2</sub>	0 - 80 °C 32 - 176 °F	± 0,33 %/°C	150 bar 2175 psi	20 bar 290 psi	4,91 cm <sup>2</sup> 0,761 in <sup>2</sup>	~ 20 - 100 (at 20°C)	1,8 m/s 70,8 in/s	39BMRV00750C

CODE	PHASING OUT from 04/2021	NEW	Cu		L		L min		F <sub>0</sub>		F <sub>1i</sub> *		F <sub>1p</sub> **		V <sub>0</sub>		~Kg	~lb	PED 2014/68/EU
			mm	inch	mm	inch	mm	inch	daN	lb	daN	lb	daN	lb	cm <sup>3</sup>	in <sup>3</sup>			
RF 750 - 010 - A	♦ RF 750 - 010 - B		10	0.39	62	2.44	52	2.05	740 ± 5%	1664	1118	2514	1343	3018	16,6	1.01	0,47	1.04	✓
RF 750 - 013 - A	RF 750 - 013 - B		13	0.51	68	2.68	55	2.17			1152	2590	1396	3139	20,4	1.24	0,48	1.06	✓
RF 750 - 016 - A	RF 750 - 016 - B		16	0.63	74	2.91	58	2.28			1176	2644	1435	3227	24,1	1.47	0,50	1.10	✓
RF 750 - 019 - A	RF 750 - 019 - B		19	0.75	80	3.15	61	2.40			1194	2685	1465	3293	27,9	1.70	0,52	1.15	✓
RF 750 - 025 - A	RF 750 - 025 - B		25	0.98	92	3.62	67	2.64			1220	2743	1507	3388	35,5	2.17	0,56	1.23	✓
RF 750 - 032 - A	RF 750 - 032 - B		32	1.26	106	4.17	74	2.91			1240	2787	1539	3460	44,3	2.70	0,61	1.34	✓
RF 750 - 038 - A	RF 750 - 038 - B		38	1.50	118	4.65	80	3.15			1251	2813	1558	3503	51,9	3.17	0,65	1.43	✓
RF 750 - 050 - A	RF 750 - 050 - B		50	1.97	142	5.59	92	3.62			1267	2848	1584	3562	67,0	4.09	0,72	1.59	✓
RF 750 - 063 - A	RF 750 - 063 - B		63	2.48	168	6.61	105	4.13			1278	2873	1602	3602	83,4	5.09	0,81	1.79	✓
RF 750 - 075 - A	RF 750 - 075 - B		75	2.95	192	7.56	117	4.61			1285	2888	1614	3628	98,5	6.01	0,88	1.94	✓
RF 750 - 080 - A	RF 750 - 080 - B		80	3.15	202	7.95	122	4.80	1287	2893	1618	3637	104,8	6.40	0,92	2.03	✓		
RF 750 - 100 - A	RF 750 - 100 - B		100	3.94	242	9.53	142	5.59	1294	2909	1629	3663	130,1	7.94	1,04	2.29	✓		
RF 750 - 125 - A	RF 750 - 125 - B		125	4.92	292	11.50	167	6.57	1300	2922	1639	3685	161,6	9.86	1,21	2.67	✓		

♦ Disposable

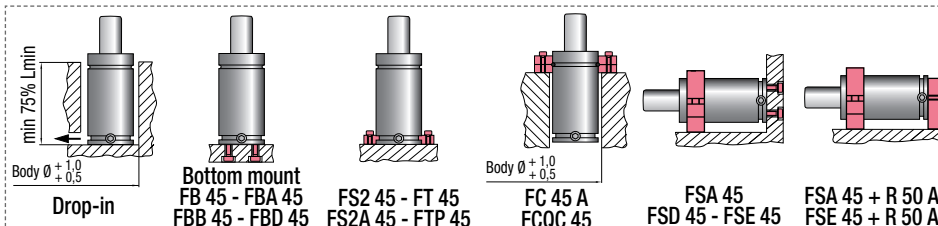

**HOW TO ORDER** p. 87

**INSTALLATION GUIDELINE** p. 205

**ACTIVE SAFETY**

OSAS



USAS



OPAS

**OSAS + OSM** = OVER STROKE ACTIVE SAFETY + OVER STROKE MARKER

Il nuovo codice sarà fornito solo ad esaurimento del vecchio

The new code will be supplied only when the old will be out of stock

Der neue Kode wird nur angegeben, wenn der alte nicht mehr lieferbar ist

Le nouveau code sera fourni uniquement lorsque le vieux stock sera épuisé

El nuevo código será suministrado sólo cuando se agoten las existencias del antiguo

O novo código irá ser fornecido apenas quando o antigo esgotar stock

 \*  $F_{1i}$  =

Isothermal end force at 100% Cu

 \*\*  $F_{1p}$  =

Polyphoric end force at 100% Cu

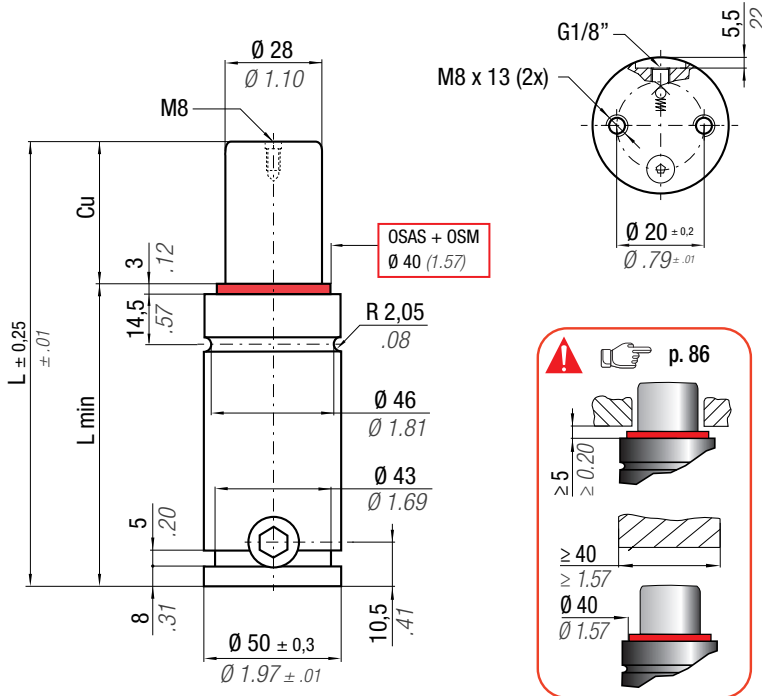

N <sub>2</sub>		0 - 80 °C 32 - 176 °F	$\Delta P$ ± 0,33 %/°C	P max 150 bar 2175 psi	P min 20 bar 290 psi	S 6,15 cm <sup>2</sup> 0.953 in <sup>2</sup>	SPM ~ 20 - 100 (at 20°C)	Max Speed 1,8 m/s 70.8 in/s	Maintenance kit 39BMRV01000C
CODE	NEW	Cu	L	L min	F <sub>0</sub>	F <sub>1i</sub> *	F <sub>1p</sub> **	V <sub>0</sub>	PED
PHASING OUT from 04/2021		mm inch	mm inch	mm inch	Initial force daN lb	End force * daN lb	End force ** daN lb	cm <sup>3</sup> in <sup>3</sup>	~Kg ~lb 2014/68/EU
RF 1000 - 013 - A	◆ RF 1000 - 013 - B	13 0.51	74 2.91	61 2.40	920 2068 ± 5% 150 bar 2175 psi + 20 °C +68 °F	1370 3079	1631 3667	28,4 1.73	0,65 1,43 ✓
RF 1000 - 016 - A	RF 1000 - 016 - B	16 0.63	80 3.15	64 2.52		1407 3163	1690 3800	33,1 2.02	0,68 1,50 ✓
RF 1000 - 019 - A	RF 1000 - 019 - B	19 0.75	86 3.39	67 2.64		1436 3229	1737 3906	37,7 2.30	0,70 1,54 ✓
RF 1000 - 025 - A	RF 1000 - 025 - B	25 0.98	98 3.86	73 2.87		1479 3326	1807 4062	47,1 2.87	0,75 1,65 ✓
RF 1000 - 032 - A	RF 1000 - 032 - B	32 1.26	112 4.41	80 3.15		1514 3403	1863 4187	58,0 3.54	0,81 1,79 ✓
RF 1000 - 038 - A	RF 1000 - 038 - B	38 1.50	124 4.88	86 3.39		1535 3451	1897 4266	67,4 4.11	0,85 1,87 ✓
RF 1000 - 050 - A	RF 1000 - 050 - B	50 1.97	148 5.83	98 3.86		1564 3517	1946 4375	86,1 5.25	0,95 2,09 ✓
RF 1000 - 063 - A	RF 1000 - 063 - B	63 2.48	174 6.85	111 4.37		1585 3564	1981 4453	106,3 6.49	1,05 2,31 ✓
RF 1000 - 075 - A	RF 1000 - 075 - B	75 2.95	198 7.80	123 4.84		1599 3594	2003 4503	125,0 7.63	1,15 2,54 ✓
RF 1000 - 080 - A	RF 1000 - 080 - B	80 3.15	208 8.19	128 5.04		1603 3605	2011 4520	132,8 8.10	1,19 2,62 ✓
RF 1000 - 100 - A	RF 1000 - 100 - B	100 3.94	248 9.76	148 5.83		1618 3636	2034 4573	164,0 10.01	1,35 2,98 ✓
RF 1000 - 125 - A	RF 1000 - 125 - B	125 4.92	298 11.73	173 6.81		1629 3663	2054 4617	202,9 12.38	1,55 3,42 ✓

◆ Disposable

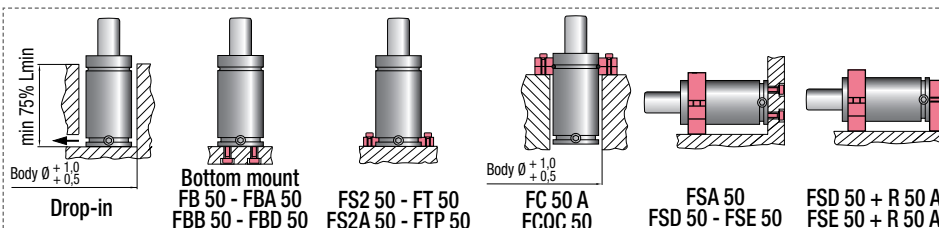
**HOW TO ORDER**

p. 87

**INSTALLATION GUIDELINE**

p. 205



**OSAS + OSM** = OVER STROKE ACTIVE SAFETY + OVER STROKE MARKER

## ACTIVE SAFETY



Il nuovo codice sarà fornito solo ad esaurimento del vecchio

The new code will be supplied only when the old will be out of stock

Der neue Kode wird nur angegeben, wenn der alte nicht mehr lieferbar ist

Le nouveau code sera fourni uniquement lorsque le vieux stock sera épuisé

El nuevo código será suministrado sólo cuando se agoten las existencias del antiguo

O novo código irá ser fornecido apenas quando o antigo esgotar stock



\*  $F_{1i} =$

Isothermal end force at 100% Cu p. 16

\*\*  $F_{1p} =$

Polytropic end force at 100% Cu

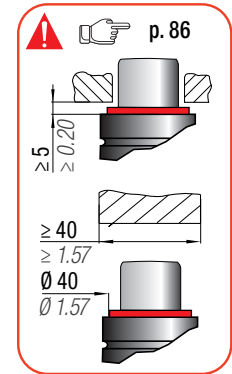
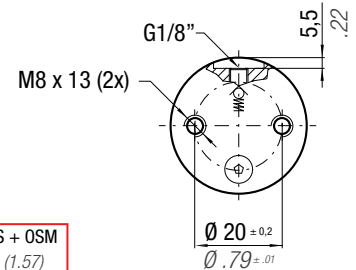
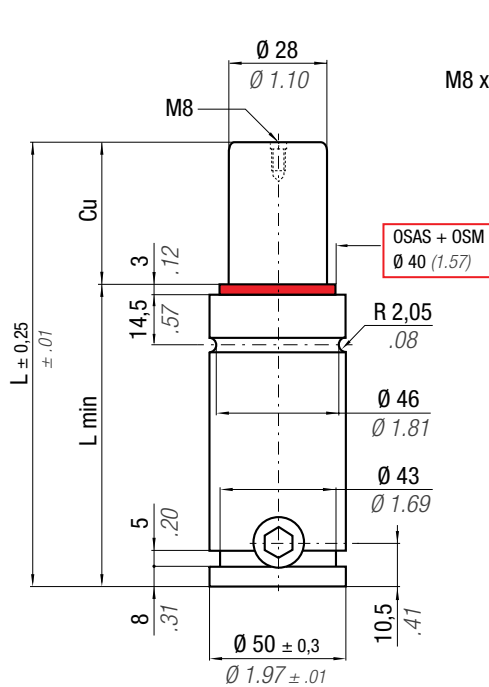

	0 - 80 °C 32 - 176 °F	$\Delta P$ ± 0,33 %/°C	P max 170 bar 2465 psi	P min 20 bar 290 psi	S 6,15 cm <sup>2</sup> 0,953 in <sup>2</sup>	SPM ~ 20 - 100 (at 20°C)	Max Speed 1,8 m/s 70,8 in/s	Maintenance kit 39BMRV01000C		
CODE PHASING OUT from 04/2021	NEW	Cu	L	L min	F <sub>0</sub>	F <sub>1i</sub> *	F <sub>1p</sub> **	V <sub>0</sub>		
		mm / inch	mm / inch	mm / inch	daN / lb	daN / lb	daN / lb	cm <sup>3</sup> / in <sup>3</sup>	~Kg / ~lb	
RF 1200 - 013 - A	♦ RF 1200 - 013 - B	13 / 0.51	74 / 2.91	61 / 2.40	1046 / 2352 ± 5% 170 bar 2465 psi + 20 °C +68 °F	1577 / 3546	1839 / 4135	28,4 / 1.73	0,65 / 1.43	✓
RF 1200 - 016 - A	RF 1200 - 016 - B	16 / 0.63	80 / 3.15	64 / 2.52		1622 / 3646	1906 / 4284	33,1 / 2.02	0,68 / 1.50	✓
RF 1200 - 019 - A	RF 1200 - 019 - B	19 / 0.75	86 / 3.39	67 / 2.64		1657 / 3725	1959 / 4403	37,7 / 2.30	0,70 / 1.54	✓
RF 1200 - 025 - A	RF 1200 - 025 - B	25 / 0.98	98 / 3.86	73 / 2.87		1709 / 3841	2037 / 4579	47,1 / 2.87	0,75 / 1.65	✓
RF 1200 - 032 - A	RF 1200 - 032 - B	32 / 1.26	112 / 4.41	80 / 3.15		1750 / 3934	2100 / 4721	58,0 / 3.54	0,81 / 1.79	✓
RF 1200 - 038 - A	RF 1200 - 038 - B	38 / 1.50	124 / 4.88	86 / 3.39		1776 / 3992	2139 / 4809	67,4 / 4.11	0,85 / 1.87	✓
RF 1200 - 050 - A	RF 1200 - 050 - B	50 / 1.97	148 / 5.83	98 / 3.86		1811 / 4072	2194 / 4932	86,1 / 5.25	0,95 / 2.09	✓
RF 1200 - 063 - A	RF 1200 - 063 - B	63 / 2.48	174 / 6.85	111 / 4.37		1836 / 4128	2233 / 5020	106,3 / 6.49	1,05 / 2.31	✓
RF 1200 - 075 - A	RF 1200 - 075 - B	75 / 2.95	198 / 7.80	123 / 4.84		1853 / 4165	2258 / 5077	125,0 / 7.63	1,15 / 2.54	✓
RF 1200 - 080 - A	RF 1200 - 080 - B	80 / 3.15	208 / 8.19	128 / 5.04		1858 / 4177	2267 / 5096	132,8 / 8.10	1,19 / 2.62	✓
RF 1200 - 100 - A	RF 1200 - 100 - B	100 / 3.94	248 / 9.76	148 / 5.83		1875 / 4215	2293 / 5156	164,0 / 10.01	1,35 / 2.98	✓
RF 1200 - 125 - A	RF 1200 - 125 - B	125 / 4.92	298 / 11.73	173 / 6.81		1889 / 4247	2315 / 5205	202,9 / 12.38	1,55 / 3.42	✓

♦ Disposable

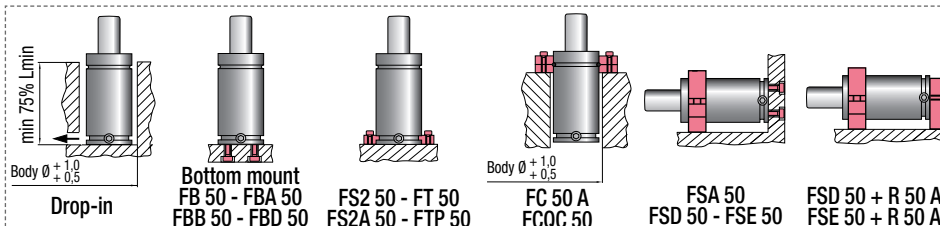

## HOW TO ORDER

p. 87

## INSTALLATION GUIDELINE

p. 205

**ACTIVE SAFETY**



OSAS



USAS

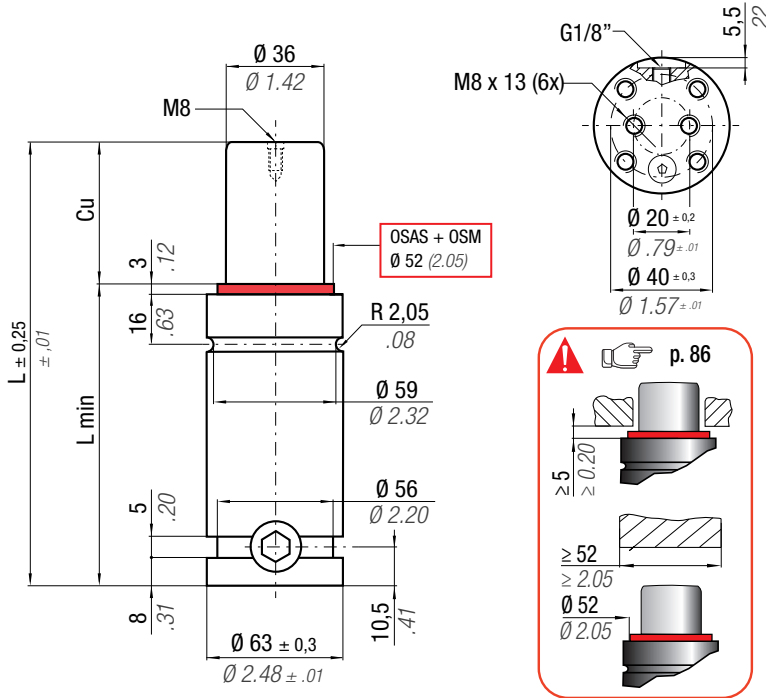

OPAS

**OSAS + OSM** = OVER STROKE ACTIVE SAFETY + OVER STROKE MARKER

Il nuovo codice sarà fornito solo ad esaurimento del vecchio

The new code will be supplied only when the old will be out of stock

Der neue Kode wird nur angegeben, wenn der alte nicht mehr lieferbar ist

Le nouveau code sera fourni uniquement lorsque le vieux stock sera écoulé

El nuevo código será suministrado sólo cuando se agoten las existencias del antiguo

O novo código irá ser fornecido apenas quando o antigo esgotar stock

 \*  $F_{1i}$  =

Isothermal end force at 100% Cu

 \*\*  $F_{1p}$  =

Polyphoric end force at 100% Cu

p. 16

p. 16

N <sub>2</sub>		0 - 80 °C 32 - 176 °F	$\Delta P$ ± 0,33 %/°C	P max 150 bar 2175 psi	P min 20 bar 290 psi	S 10,18 cm <sup>2</sup> 1.578 in <sup>2</sup>	SPM ~ 20 - 100 (at 20°C)	Max Speed 1,8 m/s 70.8 in/s	Maintenance kit 39BMRV01500C	
CODE	NEW	Cu	L	L min	F <sub>0</sub>	F <sub>1i</sub> *	F <sub>1p</sub> **	V <sub>0</sub>	PED	
PHASING OUT from 04/2021		mm inch	mm inch	mm inch	Initial force daN lb	End force * daN lb	End force ** daN lb	cm <sup>3</sup> in <sup>3</sup>	~Kg ~lb 2014/68/EU	
RF 1500 - 013 - B	◆ RF 1500 - 013 - C	13 0.51	80 3.15	67 2.64	1530 3440 ± 5% 150 bar 2175 psi	2168 4874	2546 5723	52 3.17	1,15 2.54 ✓	
RF 1500 - 016 - B	RF 1500 - 016 - C	16 0.63	86 3.39	70 2.76		2230 5012	2642 5939	60 3.66	1,18 2.60 ✓	
RF 1500 - 019 - B	RF 1500 - 019 - C	19 0.75	92 3.62	73 2.87		2279 5123	2720 6114	68 4.15	1,22 2.69 ✓	
RF 1500 - 025 - B	RF 1500 - 025 - C	25 0.98	104 4.09	79 3.11		2353 5290	2838 6380	84 5.13	1,29 2.84 ✓	
RF 1500 - 032 - B	RF 1500 - 032 - C	32 1.26	118 4.65	86 3.39		2414 5426	2935 6599	102 6.22	1,37 3.02 ✓	
RF 1500 - 038 - B	RF 1500 - 038 - C	38 1.50	130 5.12	92 3.62		2452 5512	2997 6738	118 7.20	1,44 3.17 ✓	
RF 1500 - 050 - B	RF 1500 - 050 - C	50 1.97	154 6.06	104 4.09		2506 5633	3085 6935	149 9.09	1,58 3.48 ✓	
RF 1500 - 063 - B	RF 1500 - 063 - C	63 2.48	180 7.09	117 4.61		2544 5720	3148 7078	184 11.23	1,74 3.84 ✓	
RF 1500 - 075 - B	RF 1500 - 075 - C	75 2.95	204 8.03	129 5.08		+ 20 °C +68 °F	2570 5777	3190 7172	215 13.12	1,88 4.14 ✓
RF 1500 - 080 - B	RF 1500 - 080 - C	80 3.15	214 8.43	134 5.28			2578 5797	3204 7204	229 13.97	1,94 4.28 ✓
RF 1500 - 100 - B	RF 1500 - 100 - C	100 3.94	254 10.00	154 6.06		2605 5857	3249 7303	281 17.15	2,18 4.81 ✓	
RF 1500 - 125 - B	RF 1500 - 125 - C	125 4.92	304 11.97	179 7.05		2628 5907	3286 7387	347 21.18	2,47 5.45 ✓	

◆ Disposable

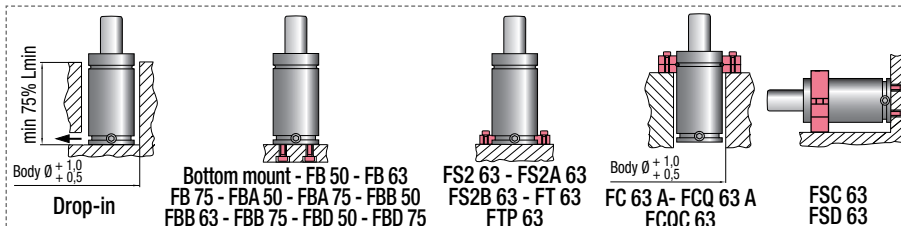
**HOW TO ORDER**

p. 87

**INSTALLATION GUIDELINE**

p. 205



**OSAS + OSM** = OVER STROKE ACTIVE SAFETY + OVER STROKE MARKER

## ACTIVE SAFETY



OSAS



USAS



OPAS

Il nuovo codice sarà fornito solo ad esaurimento del vecchio  
 The new code will be supplied only when the old will be out of stock  
 Der neue Kode wird nur angegeben, wenn der alte nicht mehr lieferbar ist  
 Le nouveau code sera fourni uniquement lorsque le vieux stock sera écoulé  
 El nuevo código será suministrado sólo cuando se agoten las existencias del antiguo  
 O novo código irá ser fornecido apenas quando o antigo esgotar stock

**easu** MANIPOL p. 247

\*  $F_{1i}$  = Isothermal end force at 100% Cu p. 16  
 \*\*  $F_{1p}$  = Polytrophic end force at 100% Cu

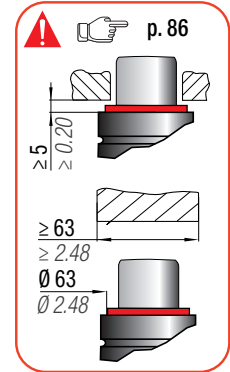
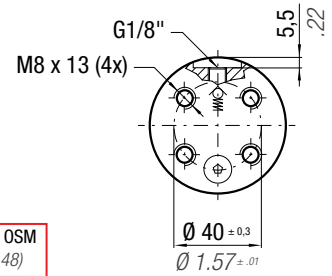
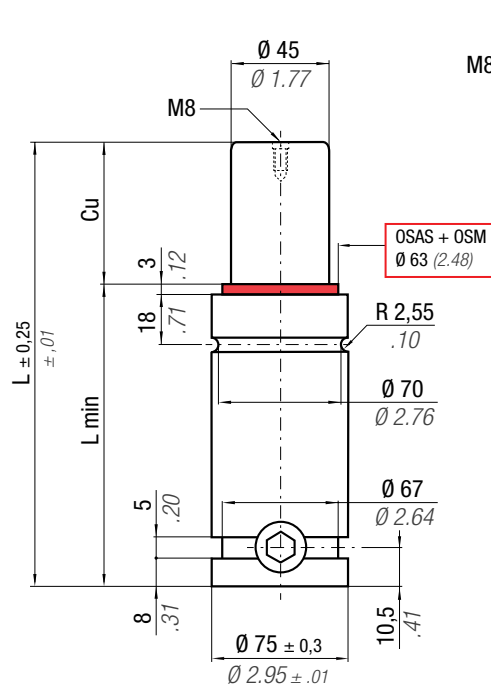

N <sub>2</sub>		0 - 80 °C 32 - 176 °F	$\Delta P$ ± 0,33 %/°C	P max 150 bar 2175 psi	P min 20 bar 290 psi	S 15,90 cm <sup>2</sup> 2,465 in <sup>2</sup>	SPM ~ 20 - 100 (at 20°C)	Max Speed 1,8 m/s 70,8 in/s	Maintenance kit 39BMRV02400D	
CODE	NEW	Cu	L	L min	F <sub>0</sub>	F <sub>1i</sub> *	F <sub>1p</sub> **	V <sub>0</sub>		
PHASING OUT from 04/2021		mm inch	mm inch	mm inch	Initial force daN lb	End force * daN lb	End force ** daN lb	cm <sup>3</sup> in <sup>3</sup>	~Kg ~lb	2014/68/EU
RF 2400 - 016 - A	♦ RF 2400 - 016 - B	16 0.63	87 3.43	71 2.80	2385 5362 ± 5% 150 bar 2175 psi + 20 °C +68 °F	3510 7891	4170 9374	92 5.61	1,68 3.70	✓
RF 2400 - 019 - A	♦ RF 2400 - 019 - B	19 0.75	93 3.66	74 2.91		3592 8075	4299 9665	104 6.35	1,73 3.81	✓
RF 2400 - 025 - A	RF 2400 - 025 - B	25 0.98	105 4.13	80 3.15		3716 8354	4498 10111	128 7.81	1,82 4.01	✓
RF 2400 - 032 - A	RF 2400 - 032 - B	32 1.26	119 4.69	87 3.43		3818 8583	4662 10481	156 9.52	1,93 4.25	✓
RF 2400 - 038 - A	RF 2400 - 038 - B	38 1.50	131 5.16	93 3.66		3883 8728	4767 10717	180 10.98	2,03 4.48	✓
RF 2400 - 050 - A	RF 2400 - 050 - B	50 1.97	155 6.10	105 4.13		3974 8935	4917 11054	228 13.91	2,21 4.87	✓
RF 2400 - 063 - A	RF 2400 - 063 - B	63 2.48	181 7.13	118 4.65		4041 9083	5026 11299	280 17.09	2,42 5.34	✓
RF 2400 - 075 - A	RF 2400 - 075 - B	75 2.95	205 8.07	130 5.12		4084 9181	5098 11461	328 20.02	2,61 5.75	✓
RF 2400 - 080 - A	RF 2400 - 080 - B	80 3.15	215 8.46	135 5.31		4099 9215	5123 11517	348 21.24	2,69 5.93	✓
RF 2400 - 100 - A	RF 2400 - 100 - B	100 3.94	255 10.04	155 6.10		4145 9318	5199 11688	428 26.12	3,00 6.61	✓
RF 2400 - 125 - A	RF 2400 - 125 - B	125 4.92	305 12.01	180 7.09	4183 9405	5264 11833	528 32.22	3,40 7.50	✓	

♦ Disposable

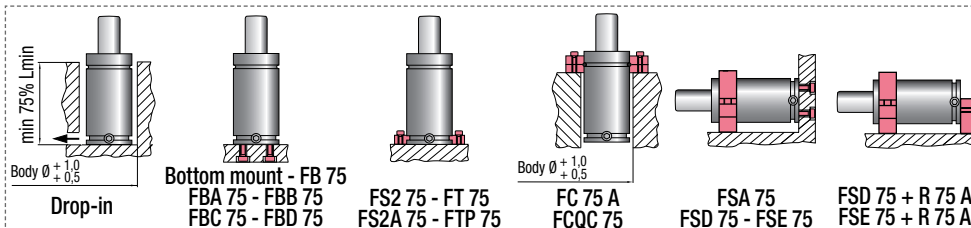

**HOW TO ORDER** p. 87

---

**INSTALLATION GUIDELINE** p. 205